

Number/Numero:

PR-22-000322

This permit is issued under the authority of section 78.3 of the *Mining Act* and the Exploration Plans and Exploration Permits Regulation (O. Reg. 308/12). It is subject to the provisions of the Act and regulation as well as the terms and conditions included in this permit.

Ce permis est émis conformément aux dispositions de section 78.3 de la *Loi sur les mines* et des règlements et est sujet aux restrictions et dispositions de ce lois et règlements ainsi qu'aux conditions ci-énoncées.

**Note: The issuance of this permit does not relieve the applicant from the responsibility of acquiring any other agency, board, government, etc. approval as may be required nor does it relieve the permittee from the requirements of any other legislation or guarantee access to the land.**

**Remarque : La délivrance de ce permis n'exempte pas le demandeur de l'obligation d'obtenir l'autorisation de tout autre organisme, commission, gouvernement, etc. qui pourrait être exigée, n'exempte pas le titulaire des dispositions de toute autre loi et ne garantit pas l'accès à la terre.**

## Project Details/ Détails sur le projet

Project Name/ Titre du projet

Skinner North Extended

Qualified Supervisor/Superviseur qualifié

Rory Ritchie

## This Permit is issued to: Ce Permis est délivré a:

Name of Permittee:/Nom du détenteur:

Prosper Gold Corporation

Mailing Address:/Adresse postale:

3500 - 1055 Dunsmuir St, PO Box 49114, Vancouver, BC, V7X 1H7

To conduct early exploration activities from/ Pour effectuer des activités d'exploration du (yyyy/mm/dd):

2023/02/03

to: 2026/02/02

On claim/lease/licence of occupation number(s):/Sur le numéro(s) du claim/bail/permis d'occupation:

101310, 116240, 116595, 116936, 117812, 120354, 120355, 121801, 121802, 128235, 152344, 159522, 159523, 160880, 165510, 166239, 168950, 178382, 178383, 194276, 202832, 214855, 215088, 224940, 232947, 235680, 262945, 269586, 270279, 270908, 280951, 290356, 291743, 298986, 314033, 320966, 341946, 551493, 551494, 551495, 551496, 551497, 551498, 551499, 551500, 551679, 551680, 551681, 551682, 551685, 551686, 551687, 551691, 551735, 593251, 593252

As per the project map(s) and Activity Details Report, all of which are attached hereto and which form part of this permit/  
Selon la/les carte(s) du projet et le Rapport Détaillé des Activités, tous qui sont attachés ici et qui forment partie du permis

for the purpose of Permit activities:

- Mechanized Drilling (assembled weight >150kg)/ Forage mécanisé (poids assemblé >150 kg)
- Mechanized Stripping (>100m<sup>2</sup> in 200m radius)/ Décapage mécanisé (>100 m<sup>2</sup> dans un rayon de 200 m)
- Pitting and Trenching (>3m<sup>3</sup> in 200m radius)/ Creusement de fosses et de tranchées (>3 m<sup>3</sup> dans un rayon de 200 m)
- Line Cutting (>1.5m width)/ Découpage des quadrillages (>1,5 m de largeur)
- Other (Early exploration activities for which Director has required a permit)/Autre (Activités d'exploration préliminaires pour laquelle le Directeur a demandé un permis):

for the purpose of Plan activities:

- Ground geophysical survey requiring a generator (Les levés géophysiques au sol qui nécessitent l'utilisation d'une génératrice)
- Mechanized Drilling (assembled weight <150kg)/ Forage mécanisé (poids assemblé <150 kg)
- Mechanized Stripping (<100m<sup>2</sup> in 200m radius)/ Décapage mécanisé (<100 m<sup>2</sup> dans un rayon de 200 m)
- Pitting and Trenching (1-3m<sup>3</sup> in 200m radius)/ Creusement de fosses et de tranchées (1-3 m<sup>3</sup> dans un rayon de 200 m)
- Line Cutting (<1.5m width)/ Découpage des quadrillages (<1,5 m de largeur)

Subject to the following conditions:/Et sous les conditions suivantes:

1. The Permittee shall keep this permit or a true copy thereof on the permit area./Le détenteur conserver ce permis ou une copie conforme sur les lieux des travaux.
2. The person in charge of the operation conducted under this permit shall produce and show this permit or the true copy kept on the exploration permit area to any inspector whenever requested by the officer./Le responsable des travaux couverts par ce permis doit produire le permis ou sa copie conforme si un inspecteur lui demande.
3. The requirements outlined in Schedule 1 of Ontario Regulation 308/12 and applicable Provincial Standards for Early Exploration/ Les exigences générales identifier à l'annexe 1 du Règlement de l'Ontario 308/12 et les normes provinciales relatives à l'exploration préliminaire.
4. Other terms and conditions as listed on this permit./Autres termes et conditions énoncées sur ce permis.

Place of Issue/Emis a:

Thunder Bay

Issued by/Emis par:

Neal Bennett, Director of Exploration

Date of Issue/Date émis (yyyy/mm/dd, aaaa/mm/jj):

2023/02/03

Signature of Director/Signature du directeur:



Additional Terms and Conditions:

Autre termes et conditions:

Collection of personal information, if any, on this form is authorized by sections 7, 78.2, 78.3, and subsection 178.2(1) of the *Mining Act* for the purpose of creating a public record as described in section 37 of of the *Freedom of Information and Protection of Privacy Act*. This information may also be posted in a modified form on the Ministry of Northern Development and Mines website and on the Environmental Registry for public comment. Questions about this collection should be directed to the Mineral Exploration and Development Section, Ministry of Northern Development and Mines, 933 Ramsey Lake Road, Sudbury ON P3E 6B5. Telephone 705-670-5815.

Preferred language of  
correspondence

- English  
 French

Fields marked with an asterisk (\*) are mandatory.

**1. Project Details**

Project Name \*

Skinner North Extended

Name of Early Exploration Proponent \*

Prosper Gold Corp.

Is the proposed early exploration area within the project area for an existing filed closure plan? \*

- Yes  No

Are there any mine hazards identified in the [Abandoned Mines Information System \(AMIS sites\)](#) in your project area? \*

- Yes  No

Enter the Universal Transverse Mercator Coordinates (UTM) in North American Datum 83 (NAD 83) Grid for the centre of your project area

Zone (N) \*

15

Easting (m) \*

507000

Northing (m) \*

5676500

**2. Exploration Logistics and Detailed Information**

Will explosives be used for any activity/activities? If yes describe in detail which activities require the explosives, where they will be stored, and any other relevant information.

No

What commodity or commodities are being sought in the work program?

Gold

How will you be transporting personnel to the exploration site for all activities? Describe in detail.

Pick-up trucks will take crews from camp to exploration site. If not truck accessible, snowmobiles will be used to transport personnel to IP grid.

How will you be mobilizing/demobilizing equipment to and from the exploration site for all activities? Describe in detail.

Pick-up trucks with trailers.

What type of equipment will you be using for all of the early exploration activities?

Pick-up trucks, 5000 kW generator, snowmobiles, transmitter, radios.

What type of drilling will take place? (e.g. core drilling, reverse circulation)

n/a

Do you anticipate the removal of the drill casing?

Yes  No

If yes, when will you be removing it?

Immediately  3 to 6 months  6 to 12 months  1 to 2 years

For the exploration activities you have selected in your early exploration submission please fill in the associated details (required for all activities proposed). \*

Geophysical surveys requiring a generator ▶ Type of Survey Induced Polarization (IP) (40 line-km)

Line cutting ▶ Estimated total line length 40000 metres

Mechanized Stripping ▶ Planned Number of stripped locations \_\_\_\_\_  
Estimated total area of stripping \_\_\_\_\_ square metres

Pitting and Trenching of Bedrock ▶ Planned Number of Pits/Trenches \_\_\_\_\_

Mechanized Drilling ▶ Planned drill hole diameter \_\_\_\_\_ centimetres  
 1 - 5 pads  
 6 - 10 pads  
 11 - 15 pads  
 16 - 20 pads  
 > 20 pads

Please identify any non-prescribed activity/activities you will be undertaking to support the prescribed early exploration activity/activities

Creating trails for the purposes of early exploration  
 Creating roads for the purposes of early exploration  
 Creating/setting up camp(s) to house personnel to perform your prescribed early exploration activities  
Number of people in camp \_\_\_\_\_ Number of camps \_\_\_\_\_  
 Ground geophysical surveys without a generator  
 Airborne geophysical surveys

Are you planning to store fuel or other hazardous materials on the property? \*

Yes  No

Please provide any other information relevant to this project.

The Company has selected a geophysical contractor who does not require cut-lines. We are permitting cut-lines just in case they back out but we don't think we will be cutting lines for this survey.

### 3. Signature

Name (Last Name, First Name)

Ritchie, Rory

Email Address

rory@prospergoldcorp.com

Signature

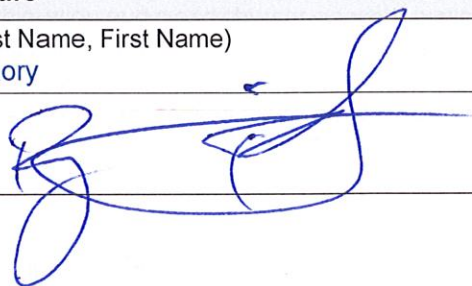

Date (yyyy/mm/dd)

2022/11/22

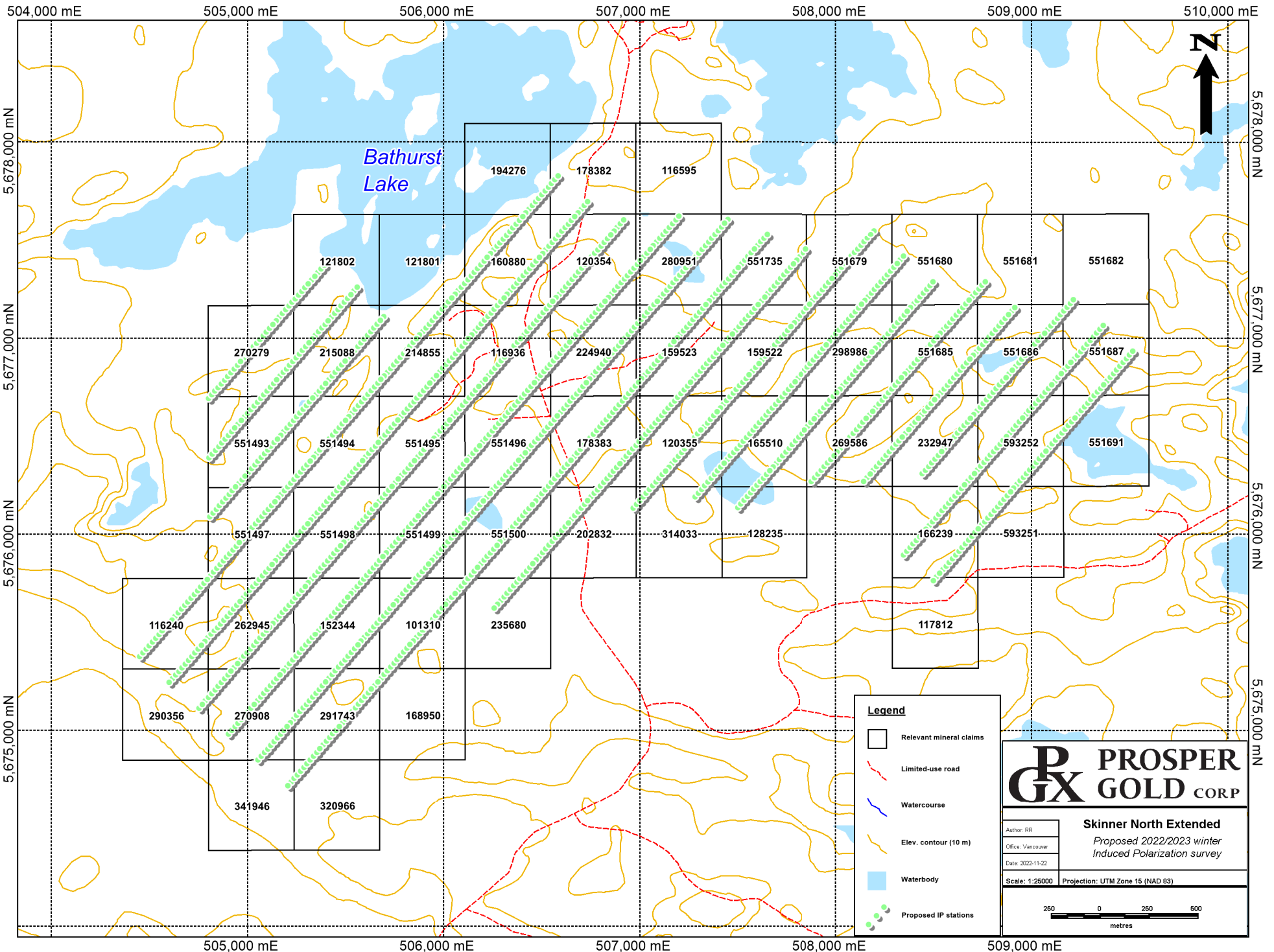

**Skinner North Extended**

*Proposed 2022/2023 winter Induced Polarization survey*

Author: RR  
Office: Vancouver  
Date: 2022-11-22

Scale: 1:25000 Projection: UTM Zone 15 (NAD 83)

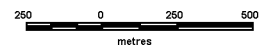

*Bathurst Lake*

