



Number/Numero:

PR-22-000003

This permit is issued under the authority of section 78.3 of the *Mining Act* and the Exploration Plans and Exploration Permits Regulation (O. Reg. 308/12). It is subject to the provisions of the Act and regulation as well as the terms and conditions included in this permit.

Ce permis est émis conformément aux dispositions de section 78.3 de la *Loi sur les mines* et des règlements et est sujet aux restrictions et dispositions de ce lois et règlements ainsi qu'aux conditions ci-énoncées.

Note: The issuance of this permit does not relieve the applicant from the responsibility of acquiring any other agency, board, government, etc. approval as may be required nor does it relieve the permittee from the requirements of any other legislation or guarantee access to the land.

Remarque : La délivrance de ce permis n'exempte pas le demandeur de l'obligation d'obtenir l'autorisation de tout autre organisme, commission, gouvernement, etc. qui pourrait être exigée, n'exempte pas le titulaire des dispositions de toute autre loi et ne garantit pas l'accès à la terre.

Project Details/ Détails sur le projet

Project Name/ Titre du projet

Campus Creek

Qualified Supervisor/Superviseur qualifié

Carey Galeschuk

This Permit is issued to: Ce Permis est délivré a:

Name of Permittee:/Nom du détenteur:

Grid Metals Corp.

Mailing Address:/Adresse postale:

Grid Metals Corp. 3335 Young Street – suite 305 Toronto ON M4N 2M1

To conduct early exploration activities from/ Pour effectuer des activités d'exploration du (yyyy/mm/dd):

2022/05/17

to:

2025/05/16

On claim/lease/licence of occupation number(s):/Sur le numéro(s) du claim/bail/permis d'occupation:

635957 635958 635959 635960 635961 635962 635963 635964 635965 635966 635967 635968 635969 635970
 635971 635972 635973 635974 635975 635976 652851 653354 653355 653356 653357 653358 653359 653360
 653361 653362 653363 653364 653365 653366 653367 653368 653369 653370 653371 653372 653373 653374
 653375 653376 653377 653378 653379 655380 655381 671231 671232 671233 671234 671235 671236
 671237 671238 671239 671240 671241 671242 671243 671244 671245 671246 671247 671248 671249 671250
 671251 671252 671253 671254 671255 671256 671257 671258 671259 671260 671261 671262 671263 671264
 671265 671266 671267 671268 671269 671270 671271 671272 671273 671274 671275 671276 671277 671278
 674458 674459 674460 674461 674462 674463 674464 674465 674466 674467 674468 674469 674470 674471
 674472 674473 674474 674475 674476 674477 674478 674479 674480 674481 674482 674483 674484 674485
 674486 674487 674488 674489 674490 674491 674492 674493 674494 674495 674496 674497 674498 674499
 674500 674501 674502 674503 674504 674505 674506 674507 674508 674509 674510 674511 676672 676673
 676674 676675 676676 676677 676678 676679 676680 676681 676682 676683 676684 676685 676686 676687
 676688 676689 676690 676691 676692 676693 676694 676695 676696 676697 676698 676699 676700 676701
 676702 676703 676704 676705 676706 676707 676708 676709 676710 676711 676712 676713 676714 676715
 676716 676717 676718 676719 676720 676721 676722 676723 676724 676725 676726 676727 676728 676729
 676730 676731 676732 676733 676734 676735 676736 676737 676738 676739 676740 676741 676742 676743

676744 676745 676746 676747 676748 676749 676750 676751 676752 676753 676754 676755 676756 676757
676758 681528 681529 681530 681531 681532 681533 681534 681535 681536 681537 681538 681539 681540
681541 681542 681543 681544 681545 681546 681547 681548 681549 681550 681551 681552 681553 681554
681555 681556 681557 681558 681559 681560 681561 681562 681563 681564 681565 681566 681567 681568
681569 681570 681571 681572 681573 681574 681575 681576 681577 681578 681579 681580 681581 681582
681583 681584 681585 681586 681587 681588 681589 681590 681591 681592 681593 681594 681595 681596
681597 681598 681599 681600 681601 681602 681603 681604 681605 681606 681607 681608 681609 681610
681611 681612 681613 681614 681615 681616 681617

As per the project map(s) and Activity Details Report, all of which are attached hereto and which form part of this permit/
Selon la/les carte(s) du projet et le Rapport Détaillé des Activités, tous qui sont attachés ici et qui forment partie du permis

for the purpose of Permit activities:

- Mechanized Drilling (assembled weight >150kg)/ Forage mécanisé (poids assemblé >150 kg)
- Mechanized Stripping (>100m² in 200m radius)/ Décapage mécanisé (>100 m² dans un rayon de 200 m)
- Pitting and Trenching (>3m³ in 200m radius)/ Creusement de fosses et de tranchées (>3 m³ dans un rayon de 200 m)
- Line Cutting (>1.5m width)/ Découpage des quadrillages (>1,5 m de largeur)
- Other (Early exploration activities for which Director has required a permit)/Autre (Activités d'exploration préliminaires pour laquelle le Directeur a demandé un permis):

for the purpose of Plan activities:

- Ground geophysical survey requiring a generator (Les levés géophysiques au sol qui nécessitent l'utilisation d'une génératrice)
- Mechanized Drilling (assembled weight <150kg)/ Forage mécanisé (poids assemblé <150 kg)
- Mechanized Stripping (<100m² in 200m radius)/ Décapage mécanisé (<100 m² dans un rayon de 200 m)
- Pitting and Trenching (1-3m³ in 200m radius)/ Creusement de fosses et de tranchées (1-3 m³ dans un rayon de 200 m)
- Line Cutting (<1.5m width)/ Découpage des quadrillages (<1,5 m de largeur)

Subject to the following conditions:/Et sous les conditions suivantes:

1. The Permittee shall keep this permit or a true copy thereof on the permit area./Le détenteur conserver ce permis ou une copie conforme sur les lieux des travaux.
2. The person in charge of the operation conducted under this permit shall produce and show this permit or the true copy kept on the exploration permit area to any inspector whenever requested by the officer./Le responsable des travaux couverts par ce permis doit produire le permis ou sa copie conforme si un inspecteur lui demande.
3. The requirements outlined in Schedule 1 of Ontario Regulation 308/12 and applicable Provincial Standards for Early Exploration/ Les exigences générales identifiées à l'annexe 1 du Règlement de l'Ontario 308/12 et les normes provinciales relatives à l'exploration préliminaire.
4. Other terms and conditions as listed on this permit./Autres termes et conditions énoncés sur ce permis.

Place of Issue/Emis a:

Thunder Bay

Issued by/Emis par:

Scott Burgess

Date of Issue/Date émis (yyyy/mm/dd, aaaa/mm/jj):

2022/05/17

Signature of Director/Signature du directeur:



Additional Terms and Conditions:

Autre termes et conditions:

Collection of personal information, if any, on this form is authorized by sections 7, 78.2, 78.3, and subsection 178.2(1) of the *Mining Act* for the purpose of creating a public record as described in section 37 of the *Freedom of Information and Protection of Privacy Act*. This information may also be posted in a modified form on the Ministry of Northern Development and Mines website and on the Environmental Registry for public comment. Questions about this collection should be directed to the Mineral Exploration and Development Section, Ministry of Northern Development and Mines, 933 Ramsey Lake Road, Sudbury ON P3E 6B5. Telephone 705-670-5815.

Preferred language of
correspondence

English

French

Fields marked with an asterisk (*) are mandatory.

1. Project Details

Project Name *

Campus Creek Pegmatites

Name of Early Exploration Proponent *

Jason Wolf

Is the proposed early exploration area within the project area for an existing filed closure plan? *

Yes No

Are there any mine hazards identified in the Abandoned Mines Information System (AMIS sites) in your project area? *

Yes No

Enter the Universal Transverse Mercator Coordinates (UTM) in North American Datum 83 (NAD 83) Grid for the centre of your project area

Zone (N) *

15

Easting (m) *

599000

Northing (m) *

5462800

2. Exploration Logistics and Detailed Information

Will explosives be used for any activity/activities? If yes describe in detail which activities require the explosives, where they will be stored, and any other relevant information.

No

What commodity or commodities are being sought in the work program?

Lithium Group metals

How will you be transporting personnel to the exploration site for all activities? Describe in detail.

Pick-up trucks will transport workers for all activities year-round. The area was extensively clear-cut 2 years ago. Access to the property and the drill sites is excellent via a network of very good, well maintained logging roads that come within 100m of most work sites. Workers can access the property by pickup truck from Ignace located 18km away - the drill sites are 11km off Trans-Canada Highway 17 along the Ila Road, an active, well maintained logging road. Access off the Ila Road is very good along well-established logging roads that extend directly to the work sites. For safety, Loggers use channel 6 to identify their current location on Ila Road and our personnel will be responsible to radio their locations at least every 2km and make safe driving decisions accordingly. Most of the exploration work will be completed at the Ila Road km 11 turn off.

How will you be mobilizing/demobilizing equipment to and from the exploration site for all activities? Describe in detail.

Access to the work sites is excellent. Flat-bed Transport Trucks will be used to bring equipment to within 100m of the sites. For drilling, pick-up trucks will deliver workers and supplies to the sites on a daily basis. A D7 and skidder will move the drill equipment from site to site via the nearby logging road. For mechanized stripping and geophysics, pick-up trucks will carry small equipment such as the wajax pump, hoses, channel saw, and geophysical equipment to the sites.

What type of equipment will you be using for all of the early exploration activities?
Mechanized Stripping - 240 linkbelt excavator, Wajax pump, 400 feet of 1 inch hose
Drilling - Drill rig, bulldozer or skidder, fuel tank, rod sloop,
Geophysics - Generator, survey instruments, chainsaw for line cutting

What type of drilling will take place? (e.g. core drilling, reverse circulation)
Diamond Drilling, NQ core

Do you anticipate the removal of the drill casing?

Yes No

If yes, when will you be removing it?

Immediately 3 to 6 months 6 to 12 months 1 to 2 years

For the exploration activities you have selected in your early exploration submission please fill in the associated details (required for all activities proposed). *

Geophysical surveys requiring a generator	▶ Type of Survey	<u>EM Ground Survey</u>	
Line cutting	▶ Estimated total line length	<u>25000</u>	metres
Mechanized Stripping	▶ Planned Number of stripped locations	<u>14</u>	
	▶ Estimated total area of stripping	<u>11200</u>	square metres
Pitting and Trenching of Bedrock	▶ Planned Number of Pits/Trenches		
Mechanized Drilling	▶ Planned drill hole diameter	<u>7.57</u>	centimetres
	<input type="checkbox"/> 1 - 5 pads		
	<input type="checkbox"/> 6 - 10 pads		
	<input type="checkbox"/> 11 - 15 pads		
	<input checked="" type="checkbox"/> 16 - 20 pads		
	<input type="checkbox"/> > 20 pads		

Please identify any non-prescribed activity/activities you will be undertaking to support the prescribed early exploration activity/activities

- Creating trails for the purposes of early exploration
 Creating roads for the purposes of early exploration
 Creating/setting up camp(s) to house personnel to perform your prescribed early exploration activities
Number of people in camp _____ Number of camps _____
- Ground geophysical surveys without a generator
 Airborne geophysical surveys

Are you planning to store fuel or other hazardous materials on the property? *

Yes No

Please provide any other information relevant to this project.

Excellent road network directly to the work sites. An short ATV trail will made to access nearby water.
There are no stream crossings. The area is mostly open clear-cut -- the Dyke of interest is on top of a granite hill where it is exposed in many places due to thin overburden that characterizes most of the area.

3. Signature

Name (Last Name, First Name)
Wolf, Jason

Email Address
nwoprospector@gmail.com

Signature

Jason Cook

Date (yyyy/mm/dd)

2022/01/05

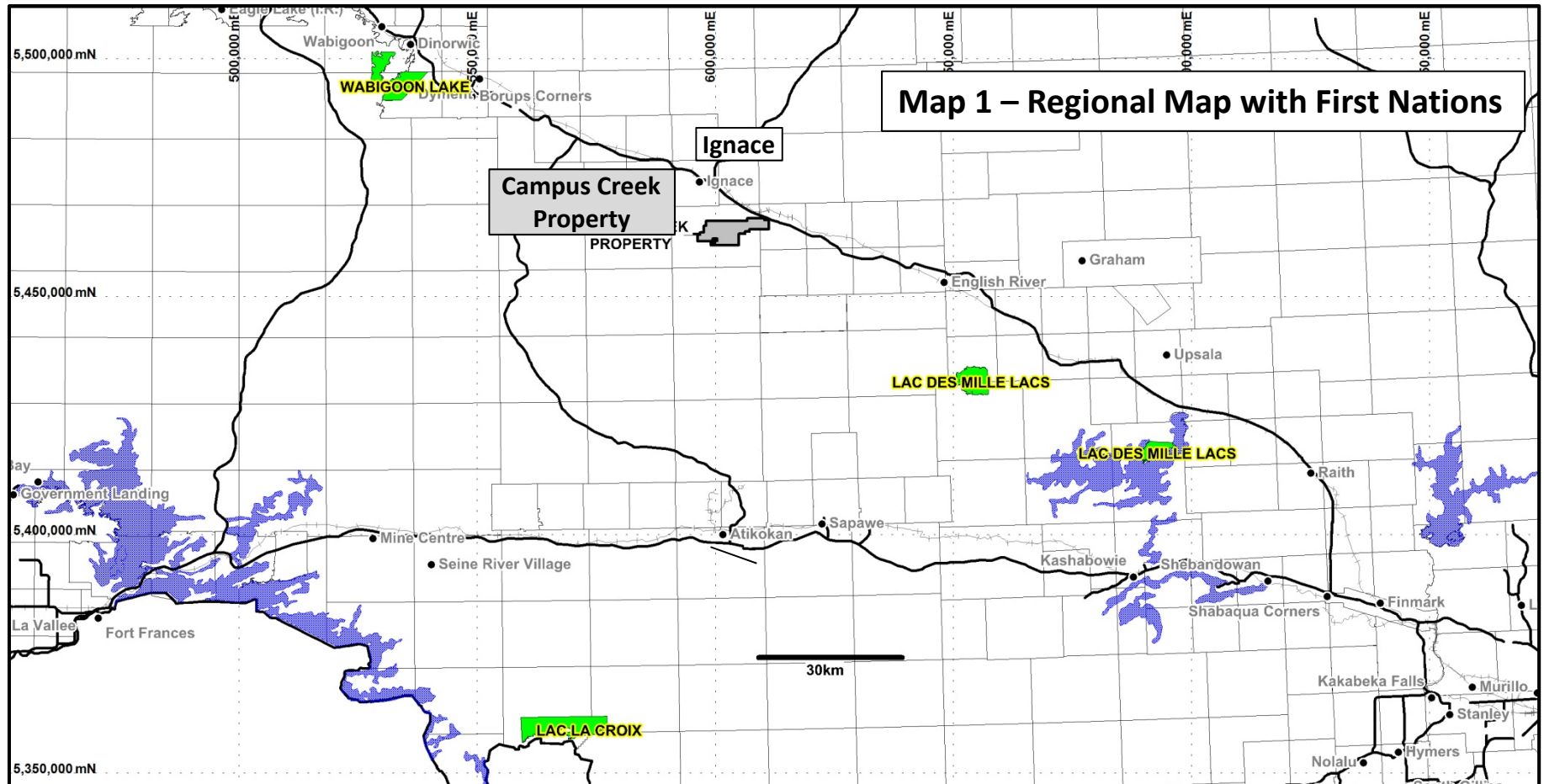

Map 1 – Regional Map with First Nations

The Campus Creek Property is located 18km by road from Ignace.
 Three First Nations have been identified for Consultation:

- Wabigoon Lake Ojibway Nation
- Lac des Mille Lacs, and
- Lac La Croix First Nation

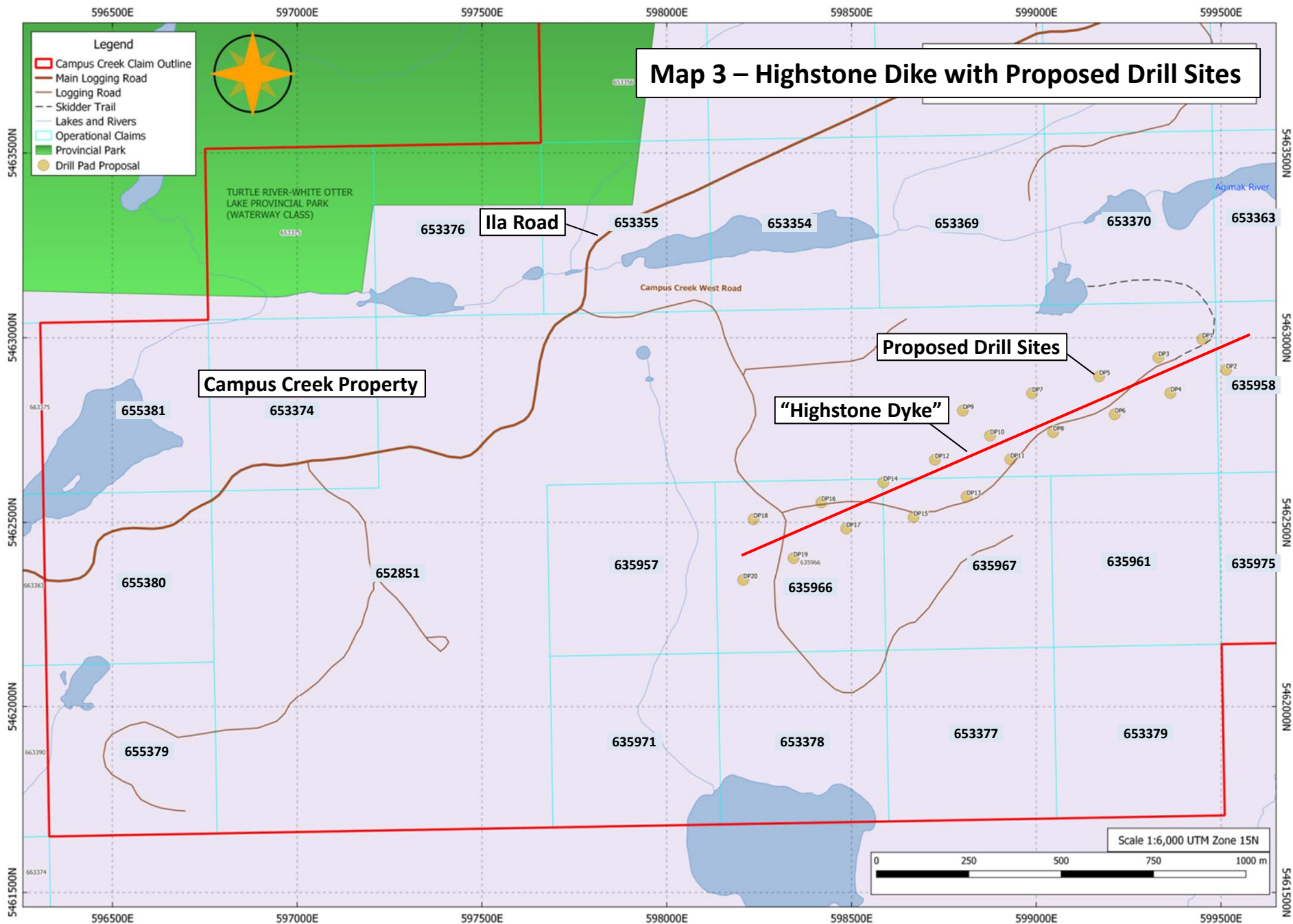

Map 3 – Highstone Dyke with Proposed Drill Sites

Campus Creek Property

Proposed Drill Sites

“Highstone Dyke”

Scale 1:6,000 UTM Zone 15N



Up to 20 sites have been proposed for drill testing the Dyke with short 50-150m holes. Access to the drill sites is very good (see maps & photos) and water is available from a small lake just north of the proposed sites. There are no stream crossings.

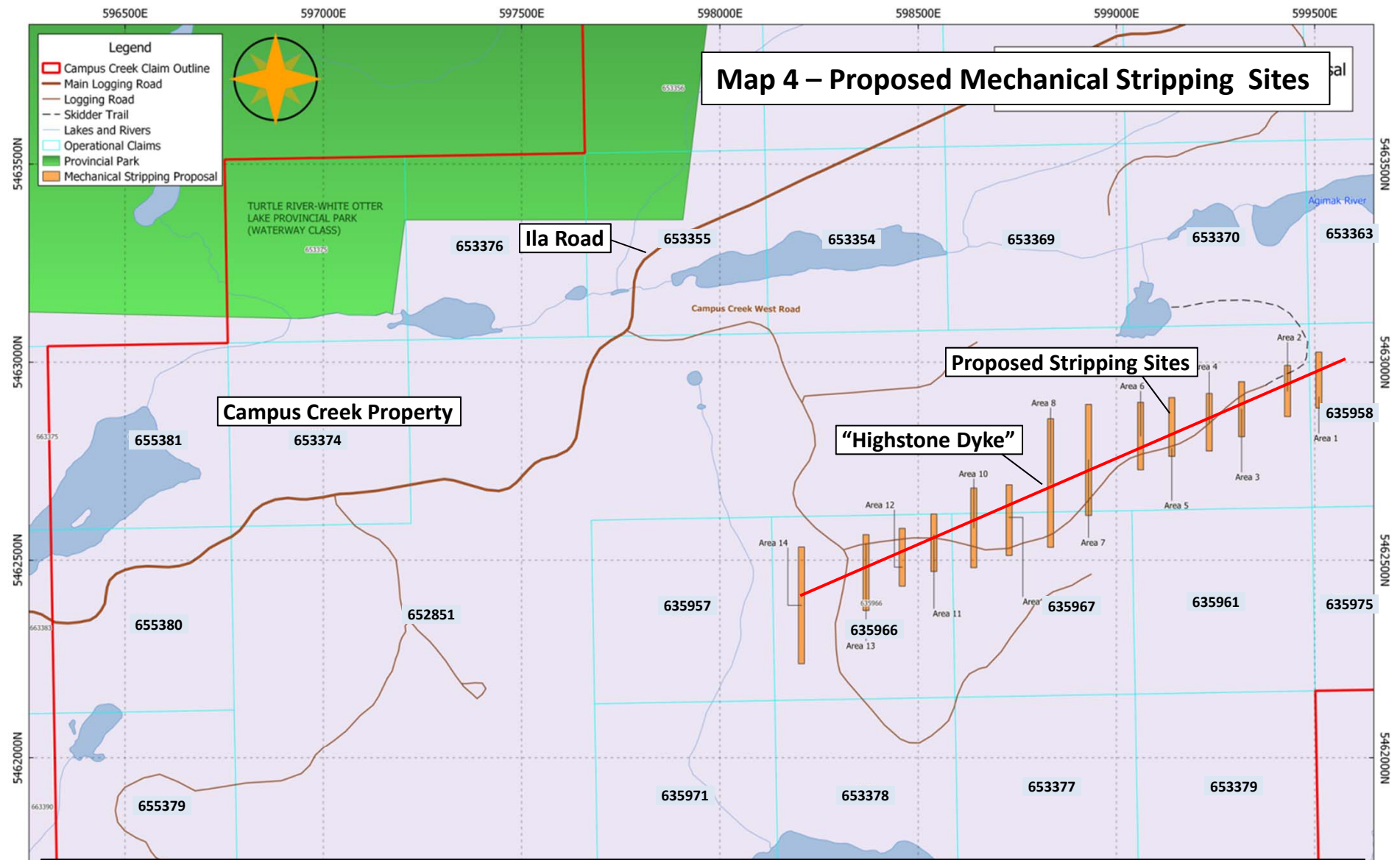

Map 4 – Proposed Mechanical Stripping Sites

Up to 14 sites have been proposed for mechanized stripping to expose the Highstone Dyke at surface. Site dimensions:

- Depth -- 0-3m deep (avg. = 1m) - there is very little overburden in the proposed area – see Photos
- Width -- 3-5m wide (avg. =4m)
- Length – 50m to 150m (avg. = 200m)
- TOTAL = 11,200m² (14 trenches x 200m L x 4m wide)

The area is very open – it has been extensively clear-cut (see photos) so there is minimal tree cutting.
 The area has a very thin cover of overburden so there is minimal material to move.

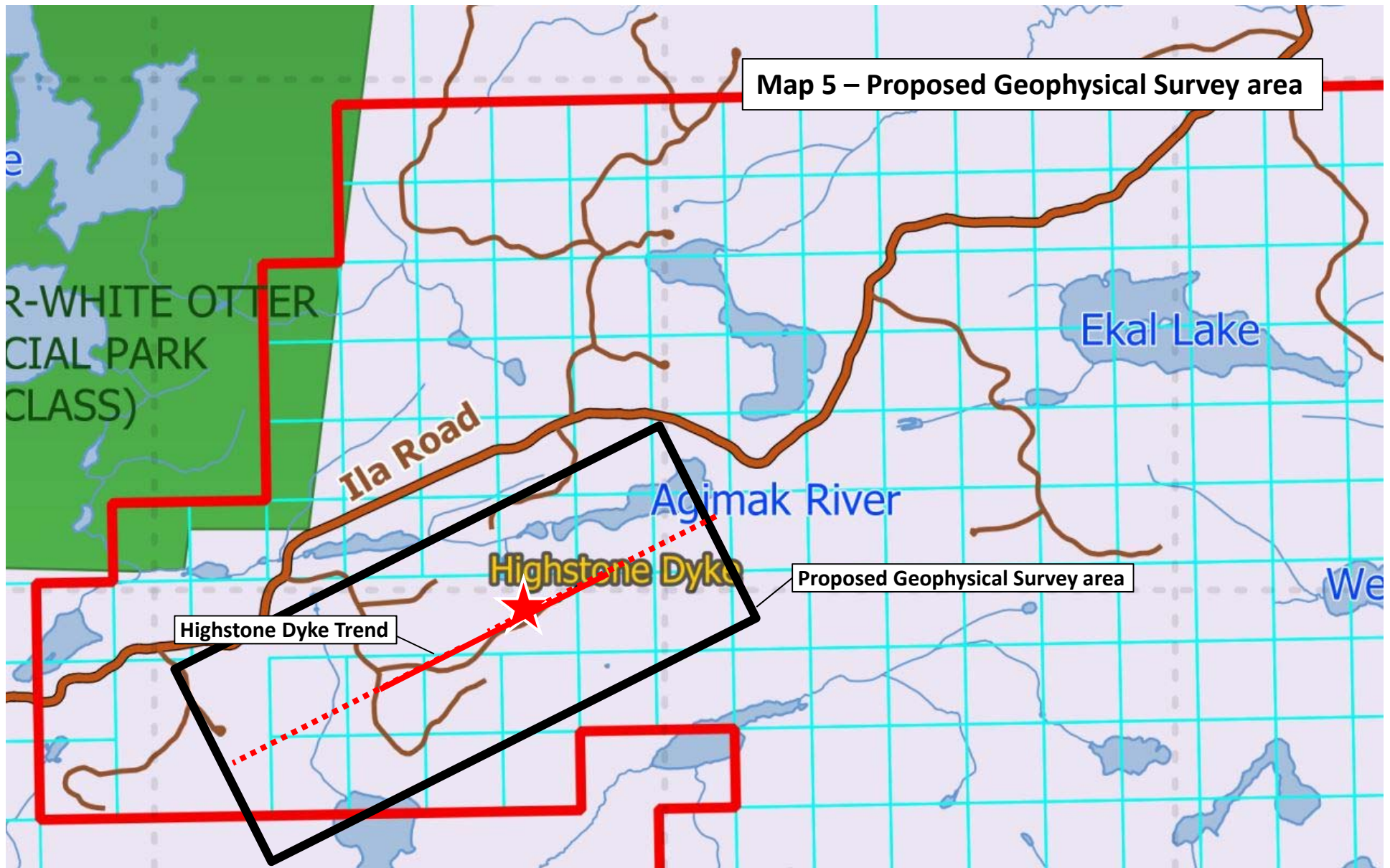

A Ground Geophysical Survey is proposed over the Highstone Dyke Trend. The Survey area (black box) measures 2.4km x 1.0km - Survey lines will be every 100m for a total of 24 line km of surveying. Much of the area is open clear-cut - so there will be line-cutting through forested areas only.



Photo A

Photo A – view from logging road to Highstone Dike – this is a typical site for the proposed drilling and mechanical stripping. Access is very good, the area is open clear-cut, and there is very thin overburden.

Photo B – view from proposed drill site to logging road – photo shows extensive network of existing skidder trails & tracks throughout the work site area.



Photo B