

BARBARA

MEADER

PIFHER

ELMHIRST

DOROTHEA

SANDRA

IRWIN

WALTERS

EVA

SUMMERS

McCOMBER

VINCENT

KITTO

BEARDMORE AREA

KILKENNY

KEEMLE LAKE AREA

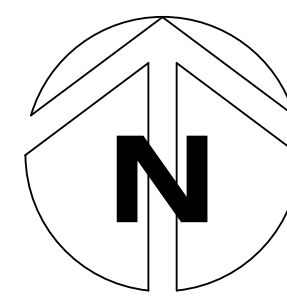

MUNICIPALITY OF GREENSTONE
OFFICIAL PLAN
Schedule A - Land Use Plan
Date: January 31, 2022 Scale 1:50,000

- Legend**
- Settlement Area Boundary
 - 1. Land Use Districts - Settlement Areas**
 - R Residential District
 - C Commercial District
 - M Industrial District
 - RU Rural District
 - ER Environmental Protection Area
 - 2. Land Use Districts - Rural Areas**
 - RU Rural Area
 - A Airport District
 - ER Environmental Protection Area
 - Waste Disposal Facility (Closed-C)
 - 500m Influence Area
 - ▨ Mineral Aggregate Resources
 - P Pit
 - Q Quarry
 - Mine Hazards
 - MMO Mineral Mining Operation
 - 3. Future Growth Area**
 - Future Growth Area Boundary
 - 4. Natural Heritage Features**
 - PSW Provincially Significant Wetlands
 - Unclassified Wetlands, includes Unstable or Organic Soils
 - Areas of Natural and Scientific Interest (ANSI)
 - Fish Habitat**
 - ⊙ Spawning Area
 - CWS Cold Water Stream
 - Wildlife Habitat**
 - MWA Moose Wintering Area
 - MAF Moose Aquatic Feeding Area
 - WCA Woodland Caribou Area
 - N Nesting Site
 - WF High Waterflow Use Area
 - 5. Transportation Facilities**
 - Provincial Park
 - == Provincial Highway
 - Municipal Roads
 - Year Round Maintained
 - Seasonally Maintained
 - Unassumed
 - Private Road
 - Rail Line
 - Abandoned Rail Line
 - Trans-Canada Pipeline
 - Water Supply Area
 - Sewage Treatment Plant
 - 6. Natural and Human Made Hazards**
 - Flood Elevation - Long Lake=326.1m (G.S.C.)
 - Hardrock Creek=332.5m (G.S.C.)
 - Lake Nipigon=260.6m (G.S.C.)
 - Kenogamis Lake 331.28m (G.S.C.)
 - Flood Fringe

Detail A1 - MacDiarmid
Not to Scale

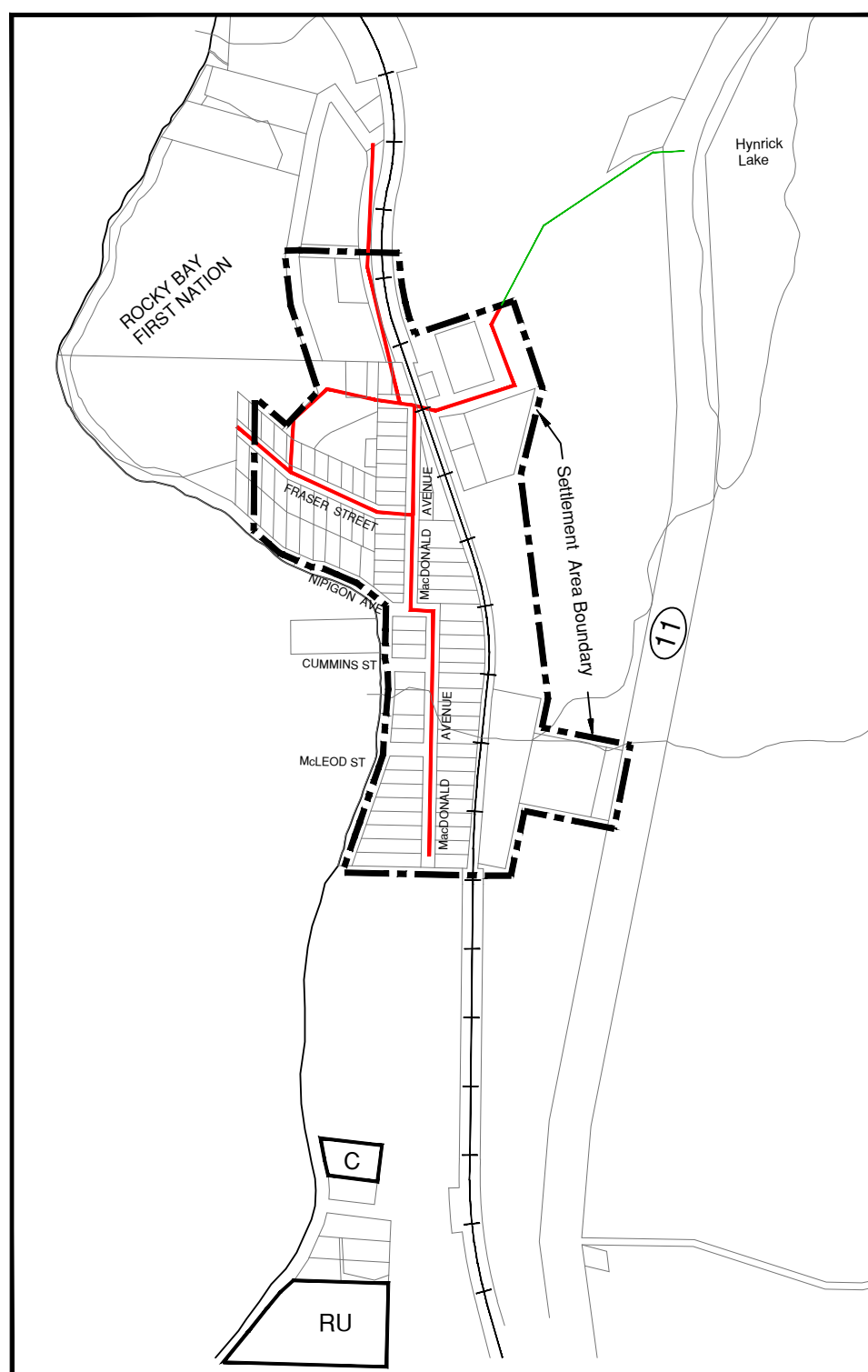

Detail A2 - Beardmore
Not to Scale

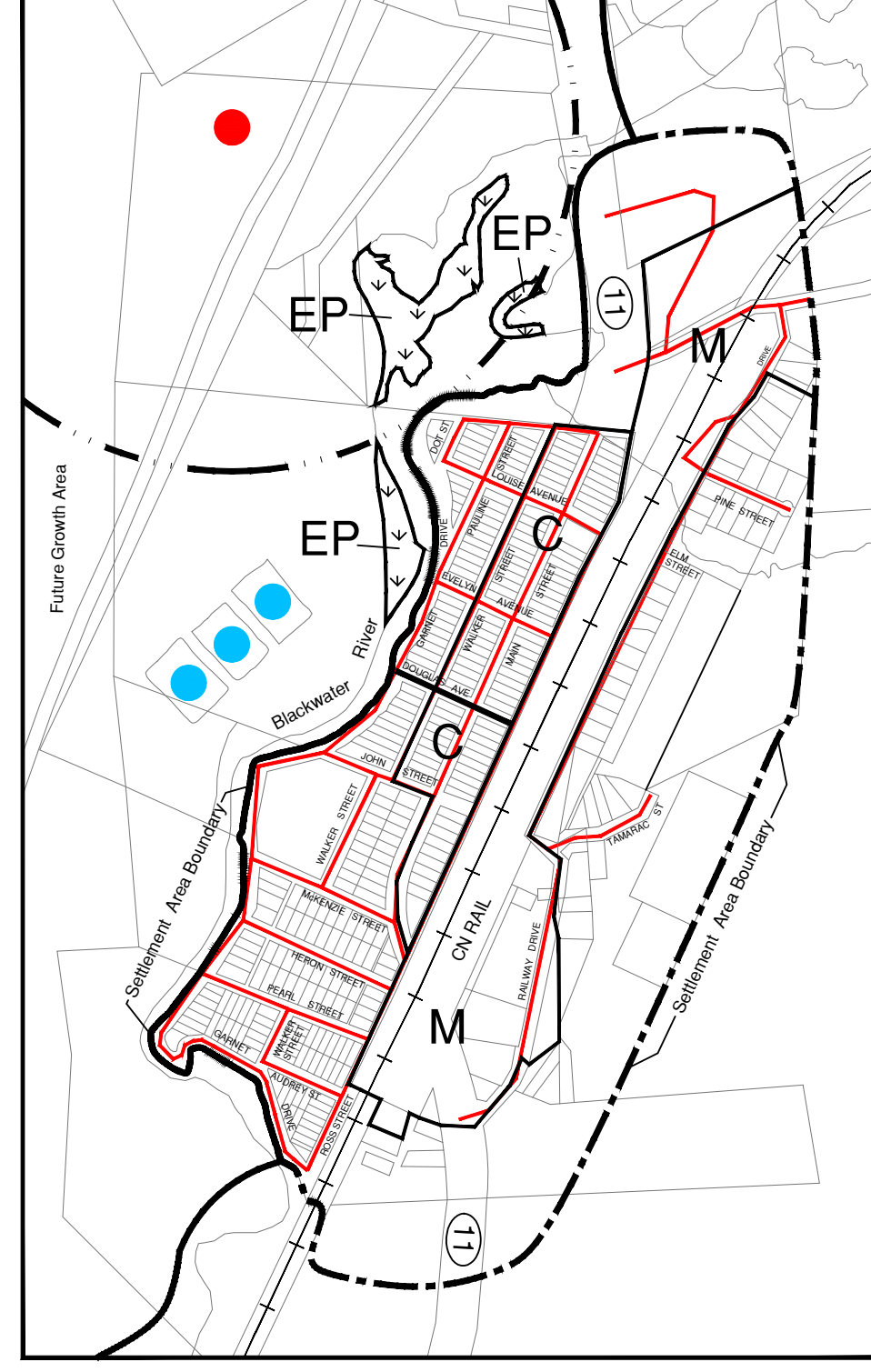

Detail A3 - Tansleyville
Not to Scale

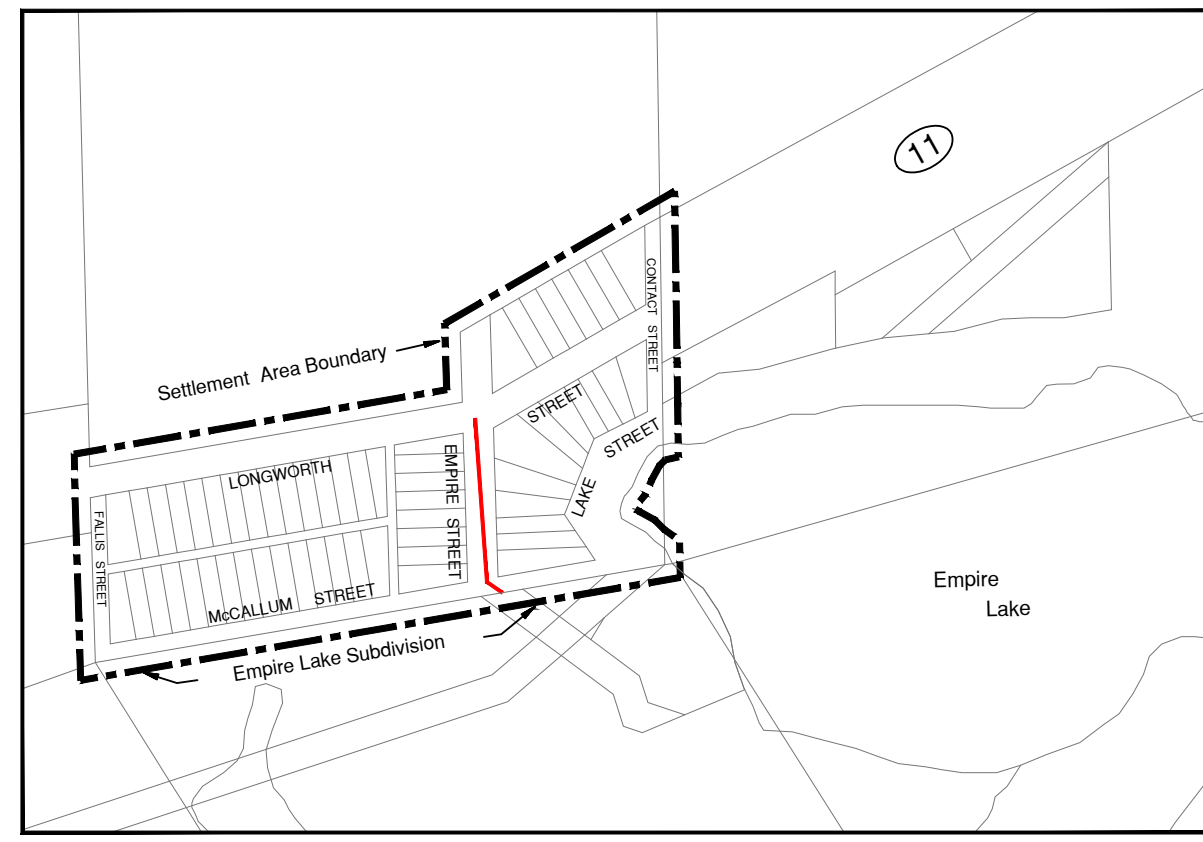

See Schedule B