



# Exploration Permit/Permis d'exploration

Number/Numero:

PR-21-000175

This permit is issued under the authority of section 78.3 of the *Mining Act* and the Exploration Plans and Exploration Permits Regulation (O. Reg. 308/12). It is subject to the provisions of the Act and regulation as well as the terms and conditions included in this permit.

Ce permis est émis conformément aux dispositions de section 78.3 de la *Loi sur les mines* et des règlements et est sujet aux restrictions et dispositions de ce lois et règlements ainsi qu'aux conditions ci-énoncées.

**Note: The issuance of this permit does not relieve the applicant from the responsibility of acquiring any other agency, board, government, etc. approval as may be required nor does it relieve the permittee from the requirements of any other legislation or guarantee access to the land.**

**Remarque : La délivrance de ce permis n'exempte pas le demandeur de l'obligation d'obtenir l'autorisation de tout autre organisme, commission, gouvernement, etc. qui pourrait être exigée, n'exempte pas le titulaire des dispositions de toute autre loi et ne garantit pas l'accès à la terre.**

## Project Details/ Détails sur le projet

Project Name/ Titre du projet

Qualified Supervisor/Superviseur qualifié

Tower Stock Gold Project (DDH-ST21)

MICHAEL STARES

## This Permit is issued to: Ce Permis est délivré a:

Name of Permittee:/Nom du détenteur:

White Metal Resources

Mailing Address:/Adresse postale:

684 SQUIER STREET, Thunder Bay ON P7B 4A8

To conduct early exploration activities from/ Pour effectuer des activités d'exploration du (yyyy/mm/dd):

2021/08/10

to:

2024/08/09

On claim/lease/licence of occupation number(s):/Sur le numéro(s) du claim/bail/permis d'occupation:

119844 134174 167123 167124 180646 186594 226748 234524 234525 268550 276378 281539 290562 302207  
305545 306412 309585 326962 334136

As per the project map(s) and Activity Details Report, all of which are attached hereto and which form part of this permit/  
Selon la/les carte(s) du projet et le Rapport Détaillé des Activités, tous qui sont attachés ici et qui forment partie du permis

for the purpose of Permit activities:

- Mechanized Drilling (assembled weight >150kg)/ Forage mécanisé (poids assemblé >150 kg)
- Mechanized Stripping (>100m<sup>2</sup> in 200m radius)/ Décapage mécanisé (>100 m<sup>2</sup> dans un rayon de 200 m)
- Pitting and Trenching (>3m<sup>3</sup> in 200m radius)/ Creusement de fosses et de tranchées (>3 m<sup>3</sup> dans un rayon de 200 m)
- Line Cutting (>1.5m width)/ Découpage des quadrillages (>1,5 m de largeur)
- Other (Early exploration activities for which Director has required a permit)/Autre (Activités d'exploration préliminaires pour laquelle le Directeur a demandé un permis):

for the purpose of Plan activities:

- Ground geophysical survey requiring a generator (Les levés géophysiques au sol qui nécessitent l'utilisation d'une génératrice)
- Mechanized Drilling (assembled weight <150kg)/ Forage mécanisé (poids assemblé <150 kg)

- Mechanized Stripping (<100m<sup>2</sup> in 200m radius)/ Décapage mécanisé (<100 m<sup>2</sup> dans un rayon de 200 m)
- Pitting and Trenching (1-3m<sup>3</sup> in 200m radius)/ Creusement de fosses et de tranchées (1-3 m<sup>3</sup> dans un rayon de 200 m)
- Line Cutting (<1.5m width)/ Découpage des quadrillages (<1,5 m de largeur)

Subject to the following conditions:/Et sous les conditions suivantes:

1. The Permittee shall keep this permit or a true copy thereof on the permit area./Le détenteur conserver ce permis ou une copie conforme sur les lieux des travaux.
2. The person in charge of the operation conducted under this permit shall produce and show this permit or the true copy kept on the exploration permit area to any inspector whenever requested by the officer./Le responsable des travaux couverts par ce permis doit produire le permis ou sa copie conforme si un inspecteur lui demande.
3. The requirements outlined in Schedule 1 of Ontario Regulation 308/12 and applicable Provincial Standards for Early Exploration/ Les exigences générales identifier à l'annexe 1 du Règlement de l'Ontario 308/12 et les normes provinciales relatives à l'exploration préliminaire.
4. Other terms and conditions as listed on this permit./Autres termes et conditions énoncées sur ce permis.

Place of Issue/Émis à:

Thunder Bay

Issued by/Émis par:

Scott Burgess, Director of Exploration

Date of Issue/Date émis (yyyy/mm/dd, aaaa/mm/jj):

2021/08/10

Signature of Director/Signature du directeur:



Additional Terms and Conditions:

Autre termes et conditions:

**I. Mobilization/Demobilization**

Written notice shall be provided to the Ministry of Northern Development and Mines as follows:

- a) not less than two (2) weeks prior to commencing the early exploration activities authorized by this Permit which, for greater certainty, shall include the mobilization of personnel and equipment to the site required for carrying out those activities;
- b) after a period of temporary suspension of activities of greater than four (4) weeks, not less than one (1) week prior to recommencing the early exploration activities authorized by this permit;
- c) not less than two (2) weeks prior to the anticipated final demobilization of personnel and equipment required for carrying out the early exploration activities authorized by this Permit; and
- d) delivered by email to  
MNDM.PlansAndPermits@ontario.ca

Collection of personal information, if any, on this form is authorized by sections 7, 78.2, 78.3, and subsection 178.2(1) of the *Mining Act* for the purpose of creating a public record as described in section 37 of the *Freedom of Information and Protection of Privacy Act*. This information may also be posted in a modified form on the Ministry of Northern Development and Mines website and on the Environmental Registry for public comment. Questions about this collection should be directed to the Mineral Exploration and Development Section, Ministry of Northern Development and Mines, 933 Ramsey Lake Road, Sudbury ON P3E 6B5. Telephone 705-670-5815.

Preferred language of  
correspondence

English

French

Fields marked with an asterisk (\*) are mandatory.

## 1. Project Details

Project Name \*

**Tower Stock Gold Project (DDH-ST21)**

Name of Early Exploration Proponent \*

**White Metal Resources**

Is the proposed early exploration area within the project area for an existing filed closure plan? \*

Yes  No

Are there any mine hazards identified in the [Abandoned Mines Information System \(AMIS sites\)](#) in your project area? \*

Yes  No

Enter the Universal Transverse Mercator Coordinates (UTM) in North American Datum 83 (NAD 83) Grid for the centre of your project area

Zone (N) \*

**16**

Easting (m) \*

**300,600**

Northing (m) \*

**5,377,000**

## 2. Exploration Logistics and Detailed Information

Will explosives be used for any activity/activities? If yes describe in detail which activities require the explosives, where they will be stored, and any other relevant information.

**No explosives plan to be used.**

What commodity or commodities are being sought in the work program?

**Au**

How will you be transporting personnel to the exploration site for all activities? Describe in detail.

**Main access to the property by pickup truck with further access gained by ATV. Existing road goes directly to the property with good access also on property**

How will you be mobilizing/demobilizing equipment to and from the exploration site for all activities? Describe in detail.

**Equipment will be mobilized/demobilized from site using pickup trucks, trailers, flat beds and ATVs.**

What type of equipment will you be using for all of the early exploration activities?

**Early exploration equipment could include; drill rig, bulldozer, flatbed trucks, rock saw, small water pump**

What type of drilling will take place? (e.g. core drilling, reverse circulation)

Exploration activities would consist of diamond core drilling with NQ holes of core diameter 75.7mm Outside diameter. >20 pads.

For stripping 5 areas will involve re-stripping of historical trenches/stripped areas with the possibility of extension. 4 area will be stripping in new areas not previous stripped.

Do you anticipate the removal of the drill casing?

Yes  No

If yes, when will you be removing it?

Immediately  3 to 6 months  6 to 12 months  1 to 2 years

For the exploration activities you have selected in your early exploration submission please fill in the associated details (required for all activities proposed). \*

Geophysical surveys requiring a generator	▶	Type of Survey	_____
Line cutting	▶	Estimated total line length	_____ metres
Mechanized Stripping	▶	Planned Number of stripped locations	<u>9</u>
		Estimated total area of stripping	<u>9999</u> square metres
Pitting and Trenching of Bedrock	▶	Planned Number of Pits/Trenches	_____
Mechanized Drilling	▶	Planned drill hole diameter	<u>4.76</u> centimetres
		<input type="checkbox"/> 1 - 5 pads	
		<input type="checkbox"/> 6 - 10 pads	
		<input type="checkbox"/> 11 - 15 pads	
		<input type="checkbox"/> 16 - 20 pads	
		<input checked="" type="checkbox"/> > 20 pads	

Please identify any non-prescribed activity/activities you will be undertaking to support the prescribed early exploration activity/activities

- Creating trails for the purposes of early exploration
- Creating roads for the purposes of early exploration
- Creating/setting up camp(s) to house personnel to perform your prescribed early exploration activities  
Number of people in camp \_\_\_\_\_ Number of camps \_\_\_\_\_
- Ground geophysical surveys without a generator
- Airborne geophysical surveys

Are you planning to store fuel or other hazardous materials on the property? \*

Yes  No

Please provide any other information relevant to this project.

May do minor trail clearing work (clearing of overgrowth) on previously existing grids/trails on the property. 4km of new trails to southern drillholes and stripping would be required and will use White Metals Patent when possible. No Camp will be on site, instead personnel will be staying and nearby hotels.

### 3. Signature

Name (Last Name, First Name)

**Salo, Cathy**

Email Address

**csalo@whitemetalres.com**

Signature

Date (yyyy/mm/dd)

**2021/05/14**

**Save Form**

**Print Form**

**Clear Form**

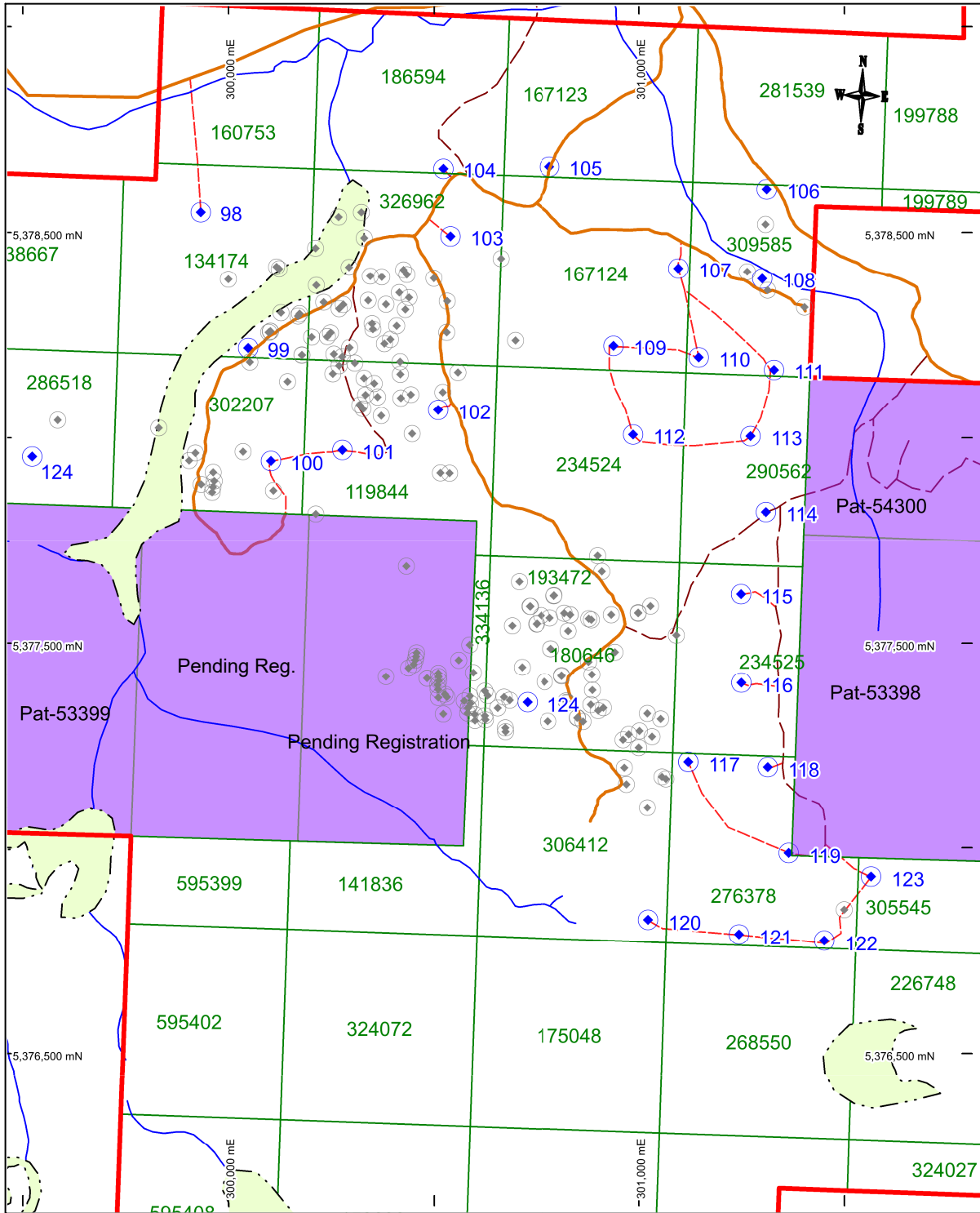

**LEGEND**

- Existing Drill Hole Collars
- Tower Stock Gold Project Boundary
- Railways
- Lakes
- Marsh
- Streams
- Utility Lines
- White Metal Claims
- White Metal Patents
- Proposed Holes for permit DDH98 M2021
- Roads
- Trails to recut as needed
- New trail to cut as needed



**White Metal Resources**

**Tower Stock Gold Project  
Proposed Drilling  
DDH#98 M2021**

Date: 2021-06-08

Author: csalo

Office:

Drawing

:LTSPDDH98MAY2021

Projection: UTM Zone 16 (NAD 83)

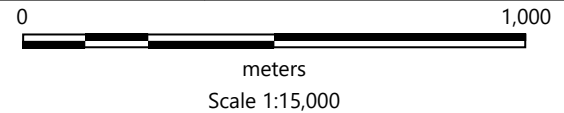

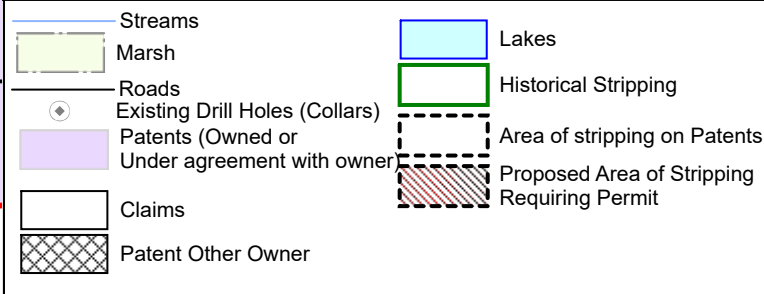
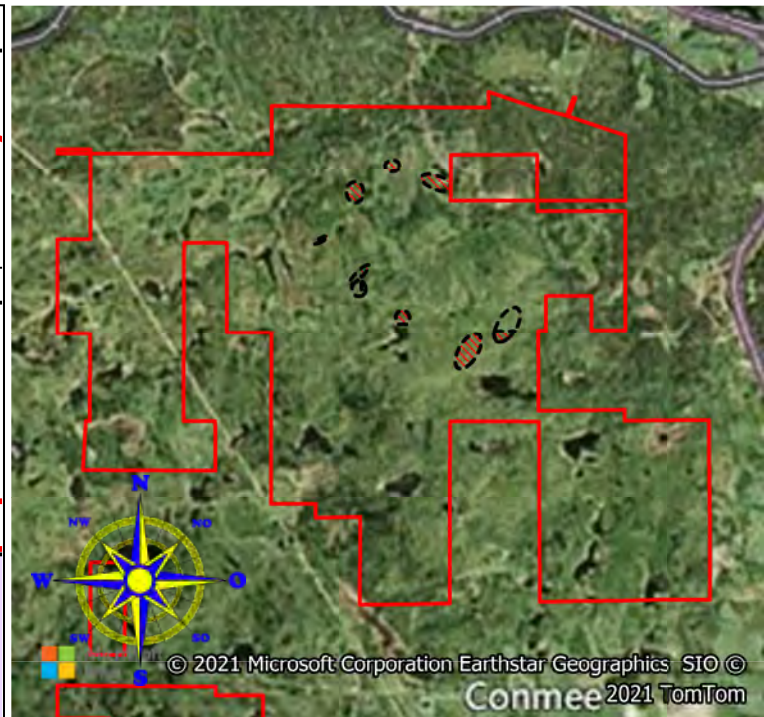
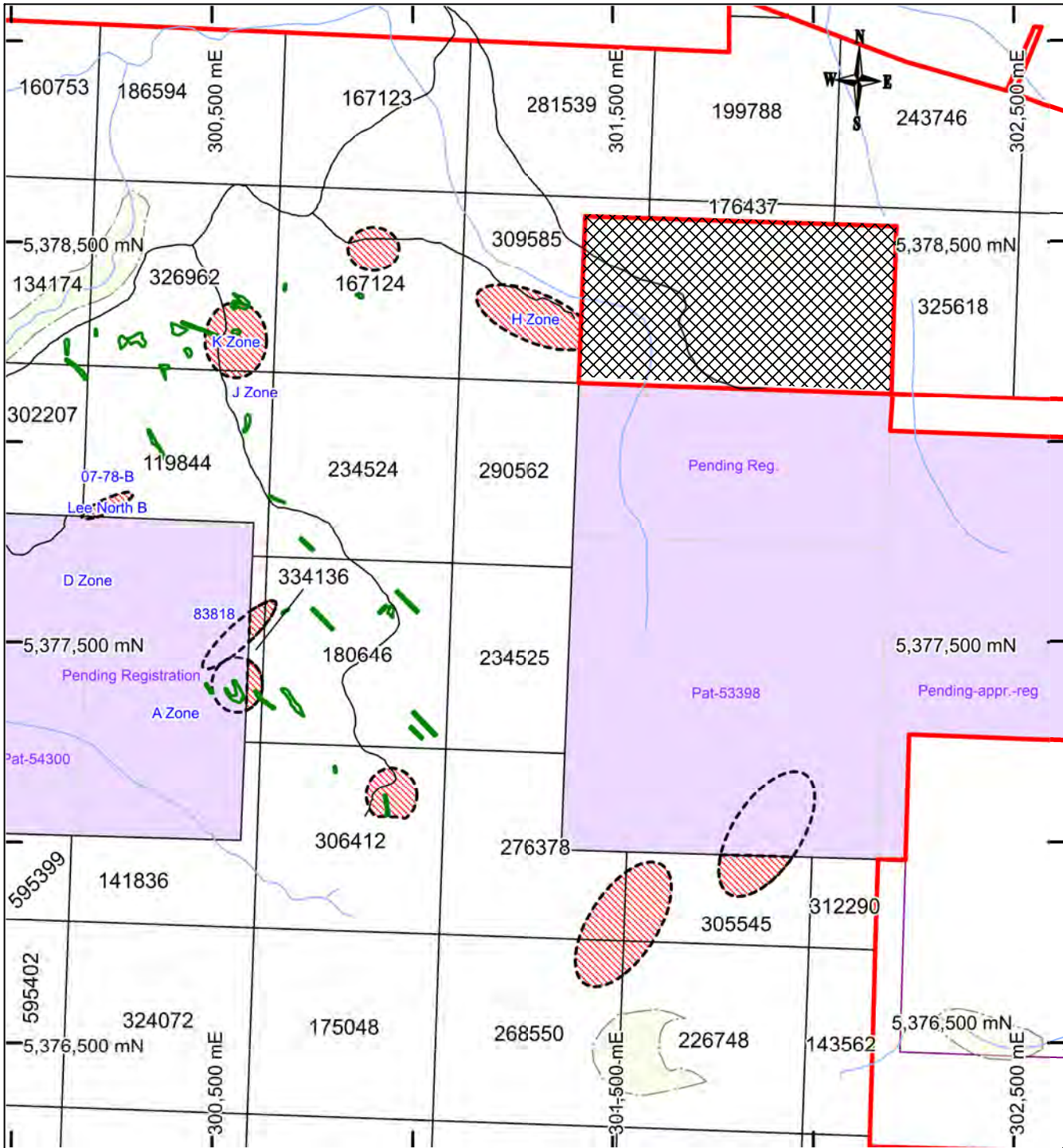

Date: 2021-05-28  
 Author: csalo  
 Office:  
 Drawing:



**Tower Stock Gold Project  
 Proposed Stripping**

Projection: UTM Zone 16 (NAD 83)

