



Exploration Permit/Permis d'exploration

Number/Numero:

PR-20-000381

This permit is issued under the authority of section 78.3 of the *Mining Act* and the Exploration Plans and Exploration Permits Regulation (O. Reg. 308/12). It is subject to the provisions of the Act and regulation as well as the terms and conditions included in this permit.

Ce permis est émis conformément aux dispositions de section 78.3 de la *Loi sur les mines* et des règlements et est sujet aux restrictions et dispositions de ce lois et règlements ainsi qu'aux conditions ci-énoncées.

Note: The issuance of this permit does not relieve the applicant from the responsibility of acquiring any other agency, board, government, etc. approval as may be required nor does it relieve the permittee from the requirements of any other legislation or guarantee access to the land.

Remarque : La délivrance de ce permis n'exempte pas le demandeur de l'obligation d'obtenir l'autorisation de tout autre organisme, commission, gouvernement, etc. qui pourrait être exigée, n'exempte pas le titulaire des dispositions de toute autre loi et ne garantit pas l'accès à la terre.

Project Details/ Détails sur le projet

Project Name/ Titre du projet

Qualified Supervisor/Superviseur qualifié

Wabicoba Lake Property Section 2

Rudolf Wahl

This Permit is issued to: Ce Permis est délivré a:

Name of Permittee:/Nom du détenteur:

Rudolf Wahl

Mailing Address:/Adresse postale:

Box 1022, 47 Graham Cre., Marathon, ON P0T 2E0

To conduct early exploration activities from/ Pour effectuer des activités d'exploration du (yyyy/mm/dd):

2021/05/04

to:

2024/05/03

On claim/lease/licence of occupation number(s):/Sur le numéro(s) du claim/bail/permis d'occupation:

532202 619344 619345 619346 619347 619348 619349 619350 619352 619353 619354 619355 619356 619357
619358 619359 619360 619361 619362 619363 619364 619365 619366 619367 619368 619369 619370 619371
619372 619373 619374 619375 619377 619378 619379 620582 620583

As per the project map(s) and Activity Details Report, all of which are attached hereto and which form part of this permit/
Selon la/les carte(s) du projet et le Rapport Détaillé des Activités, tous qui sont attachés ici et qui forment partie du permis

for the purpose of Permit activities:

Mechanized Drilling (assembled weight >150kg)/ Forage mécanisé (poids assemblé >150 kg)

Mechanized Stripping (>100m² in 200m radius)/ Décapage mécanisé (>100 m² dans un rayon de 200 m)

Pitting and Trenching (>3m³ in 200m radius)/ Creusement de fosses et de tranchées (>3 m³ dans un rayon de 200 m)

Line Cutting (>1.5m width)/ Découpage des quadrillages (>1,5 m de largeur)

Other (Early exploration activities for which Director has required a permit)/Autre (Activités d'exploration préliminaires pour laquelle le Directeur a demandé un permis):

for the purpose of Plan activities:

Ground geophysical survey requiring a generator (Les levés géophysiques au sol qui nécessitent l'utilisation d'une génératrice)

- Mechanized Drilling (assembled weight <150kg)/ Forage mécanisé (poids assemblé <150 kg)
- Mechanized Stripping (<100m² in 200m radius)/ Décapage mécanisé (<100 m² dans un rayon de 200 m)
- Pitting and Trenching (1-3m³ in 200m radius)/ Creusement de fosses et de tranchées (1-3 m³ dans un rayon de 200 m)
- Line Cutting (<1.5m width)/ Découpage des quadrillages (<1,5 m de largeur)

Subject to the following conditions:/Et sous les conditions suivantes:

1. The Permittee shall keep this permit or a true copy thereof on the permit area./Le détenteur conserver ce permis ou une copie conforme sur les lieux des travaux.
2. The person in charge of the operation conducted under this permit shall produce and show this permit or the true copy kept on the exploration permit area to any inspector whenever requested by the officer./Le responsable des travaux couverts par ce permis doit produire le permis ou sa copie conforme si un inspecteur lui demande.
3. The requirements outlined in Schedule 1 of Ontario Regulation 308/12 and applicable Provincial Standards for Early Exploration/ Les exigences générales identifier à l'annexe 1 du Règlement de l'Ontario 308/12 et les normes provinciales relatives à l'exploration préliminaire.
4. Other terms and conditions as listed on this permit./Autres termes et conditions énoncées sur ce permis.

Place of Issue/Emis a:

Thunder Bay

Issued by/Emis par:

Scott Burgess, Director of Exploration

Date of Issue/Date émis (yyyy/mm/dd, aaaa/mm/jj):

2021/05/04

Signature of Director/Signature du directeur:



Additional Terms and Conditions:

Autre termes et conditions:

1) The Permittee shall provide advance written notice of its intent to mobilize or de-mobilize personnel and equipment on the Project Site, with such notice to be provided in the following manner:
a) By electronic mail sent to ENDM to the following address: TBAY-MDLB@ontario.ca;
b) Upon mobilization: Four (4) weeks prior to initial commencement of the permitted early exploration activities and upon recommencement of any such activities following a suspension or period of inactivity of more than four (4) weeks; and
c) Upon de-mobilization: Not less than one (1) week prior to a planned suspension or period of inactivity of more than four (4) weeks or the completion of the permitted activities.

2) No early exploration activities authorized by this Permit shall be carried out on or between September 19 and October 16, each year.

Collection of personal information, if any, on this form is authorized by sections 7, 78.2, 78.3, and subsection 178.2(1) of the *Mining Act* for the purpose of creating a public record as described in section 37 of the *Freedom of Information and Protection of Privacy Act*. This information may also be posted in a modified form on the Ministry of Northern Development and Mines website and on the Environmental Registry for public comment. Questions about this collection should be directed to the Mineral Exploration and Development Section, Ministry of Northern Development and Mines, 933 Ramsey Lake Road, Sudbury ON P3E 6B5. Telephone 705-670-5815.

Preferred language of
correspondence

- English
 French

Fields marked with an asterisk (*) are mandatory.

1. Project Details

Project Name *

Wabicoaba Lake Property Section 2

Name of Early Exploration Proponent *

Wahl's Prospecting

Is the proposed early exploration area within the project area for an existing filed closure plan? *

- Yes No

Are there any mine hazards identified in the Abandoned Mines Information System (AMIS sites) in your project area? *

- Yes No

Enter the Universal Transverse Mercator Coordinates (UTM) in North American Datum 83 (NAD 83) Grid for the centre of your project area

Zone (N) *

16N

Easting (m) *

589962

Northing (m) *

5405480

2. Exploration Logistics and Detailed Information

Will explosives be used for any activity/activities? If yes describe in detail which activities require the explosives, where they will be stored, and any other relevant information.

No

What commodity or commodities are being sought in the work program?

Gold (Au), Diamonds

How will you be transporting personnel to the exploration site for all activities? Describe in detail.

Trucks, ATV's, Snowmobile, Side by side

How will you be mobilizing/demobilizing equipment to and from the exploration site for all activities? Describe in detail.

Truck/Trailer, Float (Drill rig, Bulldozer)

What type of equipment will you be using for all of the early exploration activities?

Geophysical Equipment, Drill rig, Truck, ATV, bulldozer/backhoe, chainsaw

What type of drilling will take place? (e.g. core drilling, reverse circulation)
Core drilling

Do you anticipate the removal of the drill casing?

Yes No

If yes, when will you be removing it?

Immediately 3 to 6 months 6 to 12 months 1 to 2 years

For the exploration activities you have selected in your early exploration submission please fill in the associated details (required for all activities proposed). *

Geophysical surveys requiring a generator ▶ Type of Survey _____

Line cutting ▶ Estimated total line length _____ metres

Mechanized Stripping ▶ Planned Number of stripped locations 12
Estimated total area of stripping 1000 square metres

Pitting and Trenching of Bedrock ▶ Planned Number of Pits/Trenches _____

Mechanized Drilling ▶ Planned drill hole diameter 7.57 9.6 centimetres
 1 - 5 pads
 6 - 10 pads
 11 - 15 pads
 16 - 20 pads
 > 20 pads

Please identify any non-prescribed activity/activities you will be undertaking to support the prescribed early exploration activity/activities

- Creating trails for the purposes of early exploration
 Creating roads for the purposes of early exploration
 Creating/setting up camp(s) to house personnel to perform your prescribed early exploration activities
Number of people in camp _____ Number of camps _____
- Ground geophysical surveys without a generator
 Airborne geophysical surveys

Are you planning to store fuel or other hazardous materials on the property? *

Yes No

Please provide any other information relevant to this project.

The drilling locations are an approximation. Further ground work need to be done to confirm drill locations but areas covered are prospective for further follow-up. The drill core size will be NQ or HQ. If the project moves towards resource definition HQ core will be used but for further exploration efforts NQ will be used.

3. Signature

Name (Last Name, First Name)

Wahl, Rudolf

Email Address

rwahl@renegadeisp.com

Signature

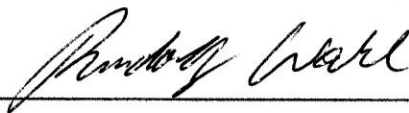

Date (yyyy/mm/dd)

2020/12/29

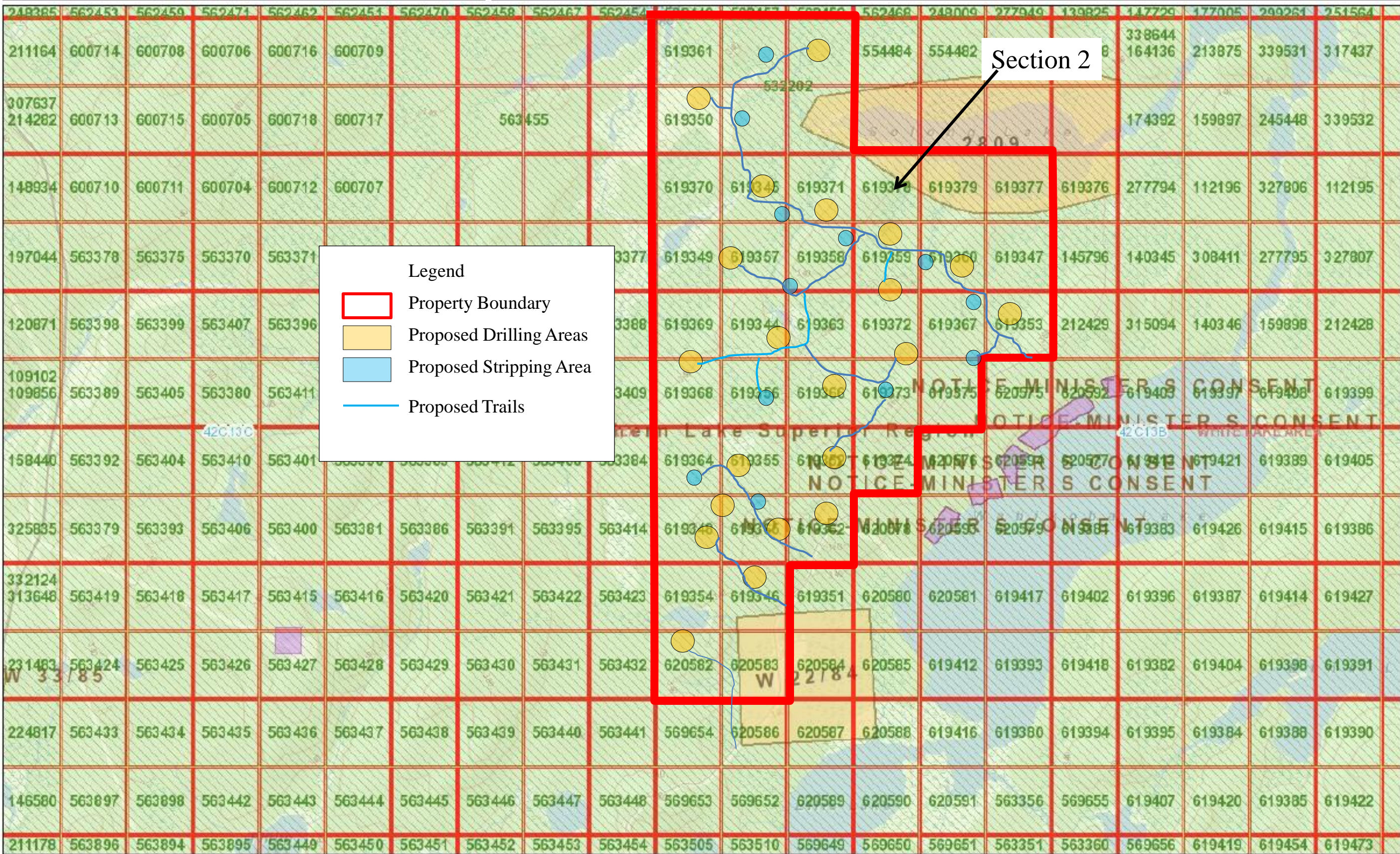

Legend

- Property Boundary
- Proposed Drilling Areas
- Proposed Stripping Area
- Proposed Trails

Legend

- Provincial Grid Cell**
 - Available
 - Pending
 - Unavailable
- Mining Claim**
 - Mining Claim
 - Boundary Claim
- Alienation**
 - Withdrawal
 - Notice
- ENDM Administrative Boundaries**
 - ENDM Townships and Areas
 - Geographic Lot Fabric
 - UTM Grid 1K
 - UTM Grid 10K
 - Mining Division
 - Mineral Exploration and Development Region
 - CLUPA Protected Area - Far North
 - Resident Geologist District
 - Federal Land Other
 - Native Reserves
- AMIS Sites**
 - AMIS Sites
 - AMIS Features
 - Drill Hole
 - Mineral Occurrences
- MLAS Mining History**
 - Withdrawal - History
 - Notice - History
 - Mining Claim - History
 - Mining Land Tenure - History
 - Legacy Claim
- Provincial Grid**
 - Provincial Grid 250K
 - Provincial Grid 50K
 - Provincial Grid Group
- Land Tenure**
 - Surface Rights
 - Mining Rights
 - Mining and Surface Rights
 - Order-in-Council

Those wishing to register mining claims should consult with the Provincial Mining Recorders' Office of the Ministry of Energy, Northern Development and Mines for additional information on the status of the lands shown hereon. This map is not intended for navigational, survey, or land title determination purposes as the information shown on this map is compiled from various sources. Completeness and accuracy are not guaranteed. Additional information may also be obtained through the local Land Titles or Registry Office, or the Ministry of Natural Resources and Forestry. The information shown is derived from digital data available in the Provincial Mining Recorders' Office at the time of downloading from the Ministry of Energy, Northern Development and Mines web site.



Imagery Copyright Notices: Ontario Ministry of Natural Resources and Forestry; NASA Landsat Program; First Base Solutions Inc.; Aero-Photo (1961) Inc.; DigitalGlobe Inc.; U.S. Geological Survey.
© Queen's Printer for Ontario, 2020

