



BROCKVILLE LONG SWAMP FEN

Provincial Park Preliminary Management Plan

2021

© 2021, Queen's Printer for Ontario

Cover photo: Fen wetland complex

Photo taken by: Chris Lewis

Additional copies of this publication can be obtained from:

Environmental Registry of Ontario

ero.ontario.ca

Charleston Lake Provincial Park

148 Woodvale Road

Lansdowne, ON

K0E 1L0

Telephone: (613) 659-2059

ISBN 978-1-4868-4327-5 (PDF)

Opportunity to Comment

Brockville Long Swamp Fen Provincial Park Preliminary Management Plan

Ontario Parks is preparing a management plan for Brockville Long Swamp Fen Provincial Park.

After careful consideration of related planning information, this preliminary management plan outlines Ontario Parks' preferred site-specific management policies for the park. For ease of review, this document is worded in the style of an approved management plan. The release of this preliminary management plan provides an opportunity for Indigenous communities, members of the public and stakeholders to be involved and provide comment. Ontario Parks will carefully consider all comments received and make changes as appropriate. Any revisions will be reflected in the approved management plan. The approved management plan will guide the management of the provincial park over the next 20 years.

You are invited to review and comment on the preliminary management plan for a period of 45 days following its release.

To assist with our review of your comments, list the topic(s) you wish to discuss and briefly state your reasons for agreeing or disagreeing with the preferred management direction. You may also make suggestions or comment on other topics that are important to you.

For further information on the preliminary management plan or the planning process, please contact:

Mike Cappello, Park Superintendent
Charleston Lake Provincial Park
148 Woodvale Road, Lansdowne, ON K0E 1L0
Tel: (613) 659-2059/ Fax: (613) 659-2095/ E-mail: planning.sez@ontario.ca

Comments should be submitted by July 15, 2021 through the Environmental Registry of Ontario at ero.ontario.ca (number 019-3451). Where unable to do so, comments should be sent to the individual identified above.

Thank you for your interest in the future management of this provincial park.

Sincerely,

Jason Travers
Director, Ontario Parks

Ontario Parks is collecting your personal information and comments under the authority of Ontario's *Provincial Parks and Conservation Reserves Act, 2006*. Your comments (not including personal information) will become part of the record of consultation and may be shared with the general public. Your personal information may be used by Ontario Parks to follow up with you upon request or when required. It will also be used to send you information about future Ontario Parks initiatives involving this provincial park. Please indicate in your response if you do not wish to be notified of new initiatives. If you have questions about the use of your personal information, please contact the individual identified above.

1 Contents

- 1 Introduction..... 1**
 - 1.1 Boundary..... 1
 - 1.2 Planning context..... 2
 - 1.3 Ecological integrity 2
 - 1.4 Indigenous communities 5
- 2 Classification 5**
- 3 Purpose, vision and objectives 5**
 - 3.1 Purpose..... 5
 - 3.2 Vision 6
 - 3.3 Objectives 6
- 4 Values..... 7**
 - 4.1 Natural heritage values 7
 - 4.2 Earth science values..... 7
 - 4.3 Cultural heritage values 7
- 5 Summary of pressures 8**
 - 5.1 Pressures on natural heritage values..... 8
 - 5.2 Pressures on cultural heritage values 8
- 6 Zoning 9**
 - 6.1 Nature Reserve Zone..... 9
- 7 Policies..... 9**
 - 7.1 Resource management policies..... 9
 - 7.1.1 Industrial activities..... 9
 - 7.1.2 Fisheries 10
 - 7.1.3 Wildlife 10
 - 7.1.4 Vegetation..... 10
 - 7.1.5 Insects and disease 11
 - 7.1.6 Species at risk..... 11
 - 7.1.7 Alien and invasive species 12

7.1.8	Fire management.....	13
7.1.9	Cultural heritage.....	13
7.1.10	Land management.....	13
7.1.11	Water management	14
7.1.12	Science and research.....	15
7.2	Recreation management policies.....	15
7.2.1	Recreation and travel.....	15
7.3	Operations and development policies	16
7.3.1	Partnerships.....	16
7.3.2	Access	17
7.3.3	Infrastructure.....	17
7.3.4	Education and heritage appreciation.....	17
8	Implementation priorities	17
9	Examination and adjustment of management plan.....	18
10	References	19

Figures

Figure 1:	Regional Context.....	3
Figure 2:	Boundary and Zoning.....	4

1 Introduction

Brockville Long Swamp Fen Provincial Park is a 174 hectare (ha) nature reserve class park. It is located within the Township of Elizabethtown-Kitley, approximately 11 kilometres (km) north of the city of Brockville, in the United Counties of Leeds and Grenville (Figure 1).

The park was established in partnership with the Nature Conservancy of Canada (NCC) and Ontario Heritage Trust (Section 7.3.1). It protects a portion of the greater Long Swamp Fen, which is a provincially significant wetland complex comprised primarily of open fen, treed fen and mixed swamp communities (Schlesinger, 1987; White, 1992). The wetland supports a diversity of significant and sensitive species, including species unique to this type of habitat. It is an important headwater wetland and recharge zone for the Rideau and South Nation rivers (Conrad, 2001). The park also protects part of a provincial life science Area of Natural and Scientific Interest (ANSI) and Significant Woodlands (as identified in the Township of Elizabethtown-Kitley Official Plan). The fen communities of the wetland complex, the relatively undisturbed ecological function and the high landscape connectivity have been identified as the most important features requiring protection (White, 1992). Protected lands and natural features are relatively underrepresented in this portion of the province making these lands of particular importance.

This management plan provides the long-term direction for managing Brockville Long Swamp Fen Provincial Park, including the purpose, vision, objectives, management policies, zoning and implementation priorities.

1.1 Boundary

Brockville Long Swamp Fen Provincial Park is located in southern Ontario, approximately 11 km north of the City of Brockville. The park lies in a rural landscape that is primarily comprised of agricultural areas (Schlesinger, 1987). County Road 6 runs north from the City of Brockville and bisects part of the park (Figure 1).

The land was acquired through a partnership between the Ministry of Natural Resources and Forestry (MNR), NCC and Ontario Heritage Trust (now called Ontario Heritage Foundation) from 1994 – 1996, and in 2005. The park was established in 2017. It consists of four separate areas of land, some of which is Crown land and some retained by NCC, all within Concession 6 in the Geographic Township of Elizabethtown (Figure 2):

- Two adjacent parcels forming an irregular shape (18 ha) in the northern end of Lot 1 that was acquired by NCC in 1994;
- One roughly rectangular parcel (36 ha) in the east half of Lot 3 that was acquired by NCC in 1995;
- Two adjacent parcels of irregular shape (61 ha) in the central portion of Lot 6 that were acquired by the Ministry of Natural Resources (MNR) in 1996 and 2005; and,
- One roughly rectangular parcel (59 ha) in the north half of Lots 7 and 8 that was acquired by NCC in 1994.

The park boundary largely follows straight-line limits of parcel lots (Figure 2). Most of the park is wetland with small pockets of upland area. The park is surrounded by privately owned land with the exception of the adjacent municipal road allowances for County Road 6, Seeker Road to the north, and the 6th Concession Road to the south.

1.2 Planning context

The *Provincial Parks and Conservation Reserves Act, 2006* (PPCRA) states that management direction must be prepared for each provincial park in Ontario. The preparation of this management plan meets that requirement.

This management plan has been developed consistent with all relevant legislation and provincial policies, including the PPCRA, and Ontario Provincial Parks: Planning and Management Policies, 1992 Update (MNR 1992). It is intended to guide park management for the next 20 years.

Other legislation (e.g., *Endangered Species Act, 2007*, *Ontario Heritage Act, 1990*), policies, initiatives (e.g., climate change, invasive species) and best practices (e.g., adaptive management, landscape level planning) also provide additional direction for protecting Ontario's biodiversity and contribute to guiding protected area planning and management.

1.3 Ecological integrity

One of the principles guiding park planning and management in the PPCRA is that maintenance of ecological integrity shall be the first priority, and that restoration of ecological integrity shall be considered.

FIGURE 1

REGIONAL SETTING

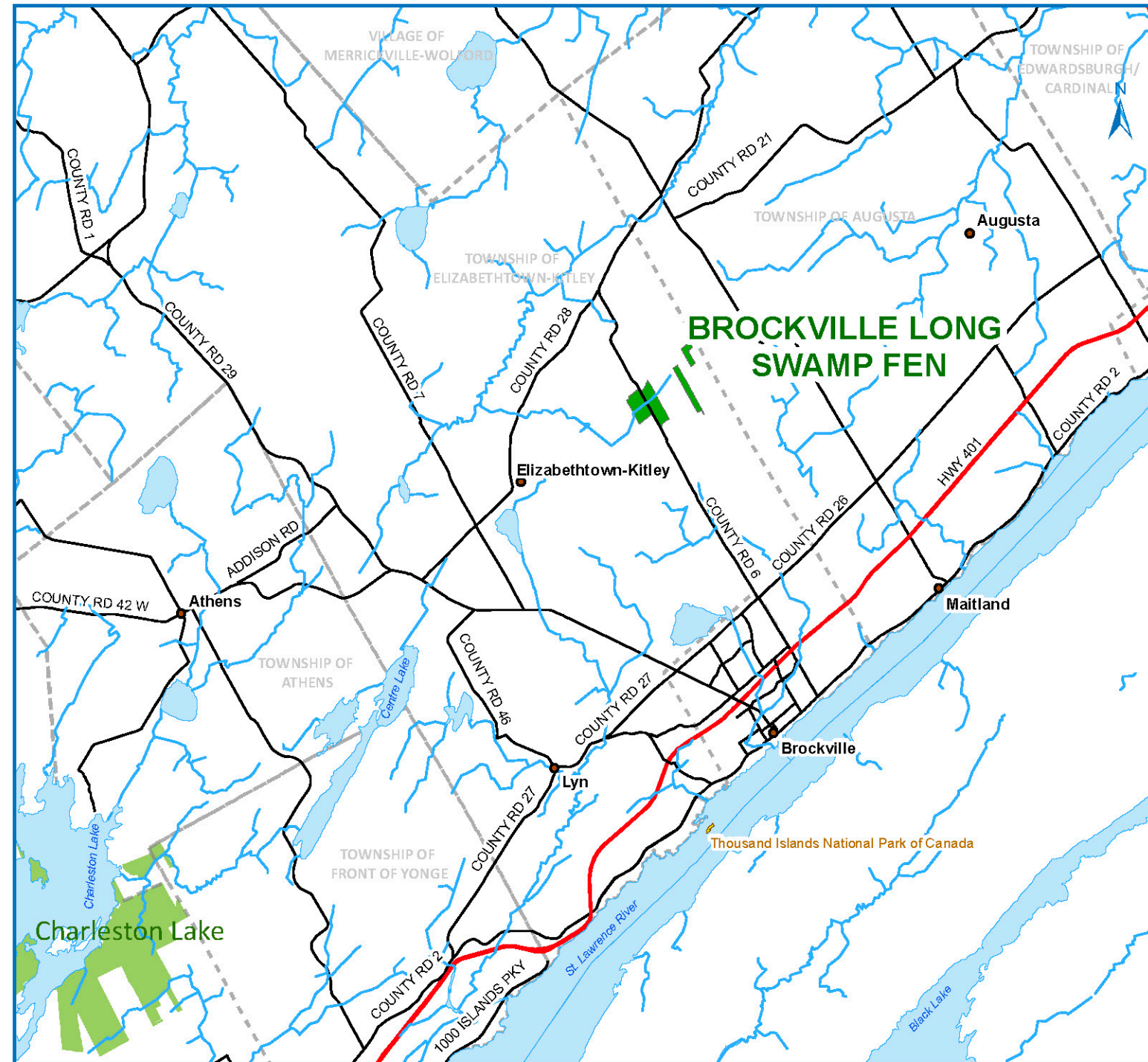

Brockville Long Swamp Fen

Area Features

- Brockville Long Swamp Fen Provincial Park
- Provincial Park
- Federal Protected Area

Base Features

- Cities
- Stream
- Waterbody
- Expressway/Highway/Freeway
- Arterial Roads
- Municipality

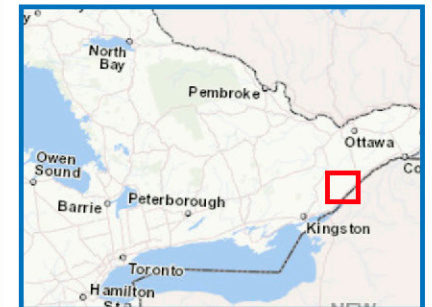

Date Published: 10/21/2020
© 2020, Queen's Printer for Ontario

This map should not be relied on as a precise indicator of routes or locations, nor as a guide to navigation. The Ontario Ministry of the Environment, Conservation and Parks (MECP) shall not be liable in any way for the use of, or reliance upon, this map or any information on this map.

Coordinate System: NAD 1983 UTM Zone 18N
Transverse Mercator
Data Sources: (Base Data - Land Information Ontario)
Map Produced By: Southeast Zone GIS Tech

FIGURE 2

PARK BOUNDARY AND ZONING

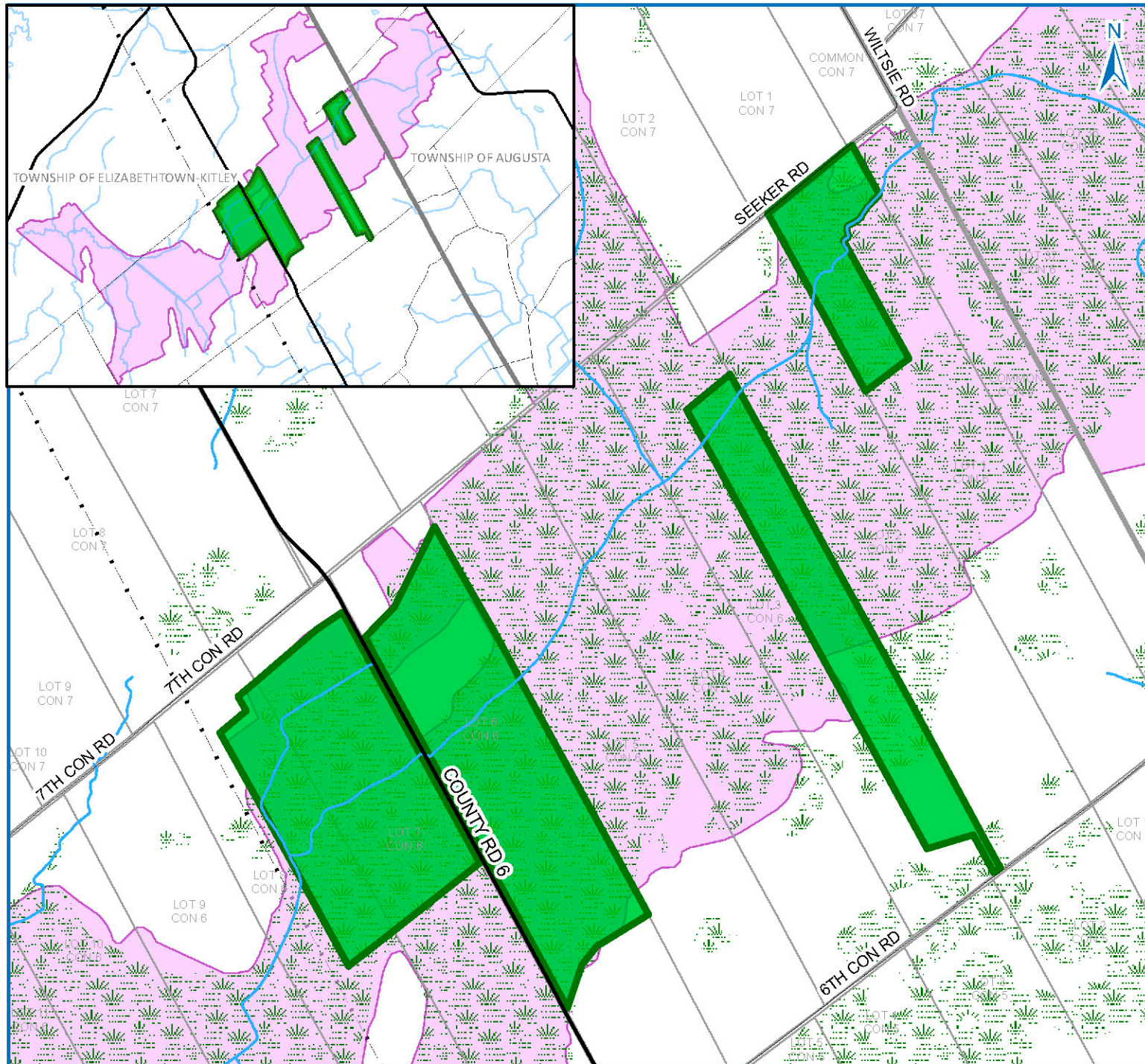

Park Zones

Nature Reserve Zone

Base Features

- Arterial Roads
- All Other Roads
- Hydro Line
- Stream
- Waterbody
- Lot Fabric
- Wetland
- ANSI, Life Science
- Provincial Park Boundary

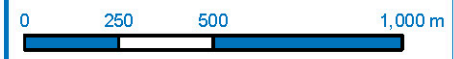

Date Published: 10/23/2020
 © 2020, Queen's Printer for Ontario

This map should not be relied on as a precise indicator of routes or locations, nor as a guide to navigation. The Ontario Ministry of the Environment, Conservation and Parks (MECP) shall not be liable in any way for the use of, or reliance upon, this map or any information on this map.

Coordinate System: NAD 1983 UTM Zone 18N
 Transverse Mercator
 Data Sources: (Base Data - Land Information Ontario)

A park has ecological integrity when:

- ecosystems have all the parts (both living and non-living) that you would expect to find; and,
- natural functions and rates of change are happening normally.

This management plan identifies site-specific management policies and actions intended to maintain or, where possible, restore ecological integrity.

1.4 Indigenous communities

Brockville Long Swamp Fen Provincial Park is within the traditional territory of the Anishinaabe Peoples in the treaty area of Crawford's Purchases, and within the proposed Algonquins of Ontario Settlement Area.

Nothing in this park management plan shall be construed so as to abrogate or derogate from the protection provided for the existing Aboriginal or treaty rights of the Indigenous peoples of Canada as recognized and affirmed in section 35 of the *Constitution Act, 1982*.

2 Classification

Brockville Long Swamp Fen Provincial Park is a nature reserve class park.

Nature reserve class parks are areas selected to protect representative ecosystems and provincially significant elements of Ontario's natural heritage, including distinctive natural habitats and landforms, for their intrinsic value, to support scientific research, and to maintain biodiversity.

3 Purpose, vision and objectives

3.1 Purpose

The purpose of Brockville Long Swamp Fen Provincial Park is to permanently protect the important natural values of the park, specifically its provincially significant wetland complex and rare and sensitive fen communities, as well as to maintain ecosystem services such as: habitat diversity, natural landscape connectivity and climate change resilience.

3.2 Vision

The vision for the park is for it to be a place of biological diversity and scientific interest with minimized human disturbance. This provincially significant wetland habitat will be protected, and its ecosystem functions preserved.

3.3 Objectives

The objectives of the PPCRA for establishing and managing provincial parks in Ontario are to provide protection as well as opportunities for ecologically sustainable recreation, heritage appreciation and scientific research. This nature reserve class park has no authorized trails or facilities and public use is not encouraged, in an effort to protect wetland flora and fauna sensitive to trampling. For this reason, there is no recreation or heritage appreciation objective.

Protection

The protection objectives for the park are to:

- ensure that the ecological integrity of the wetland is maintained, assuring long-term preservation of its natural values, such as hydrological functions, habitat diversity, landscape connectivity and plant and wildlife communities;
- monitor and manage unauthorized access and use to maintain and, where possible, enhance the relatively undisturbed nature of the wetland;
- continue to protect and monitor species at risk, provincially significant species and vegetation communities and their habitats; and,
- ensure appropriate protection of any cultural heritage values identified in the park.

Scientific research

The scientific research objectives for the park are to:

- support and encourage research and monitoring related to the natural and cultural heritage values, and in particular research priorities (Section 7.1.12) of the park; and,
- use information gathered from research and monitoring to inform park management and decision making in the park and across the broader landscape.

4 Values

4.1 Natural heritage values

Brockville Long Swamp Fen Provincial Park is located within Ecodistrict 6E-11, at the eastern edge of the Frontenac Axis portion of the Canadian Shield. The Ecodistrict is characterized by cropland or pasture and deciduous forests (Wester et al., 2018) and is comprised of three major landforms: limestone plain, organic (muck and peat) and clay plain (White, 1992).

Most of the land within the park is part of the greater Long Swamp Fen, which is designated both as the Brockville Long Swamp Fen Life Science ANSI and as a provincially significant wetland. The wetland is relatively undisturbed (Conrad, 2001).

Park lands include representation of shrub fen, treed fen, treed swamp, thicket swamp, and shallow marsh communities, as well as various upland deciduous and mixed-wood forest communities (Conrad, 2001). The fen communities protected by the park are uncommon in southern Ontario. The park also contains representation of till plain-based mixed-wood forest (White, 1992), along with old fields and early seral stage deciduous forests that fall outside of the ANSI boundary.

The park supports a rich assortment of plants and animals, including several species at risk and provincially significant and regionally rare species. The park also provides habitat for five species (western chorus frog, spring peeper, moose, black ash and eastern hemlock) that are considered moderately vulnerable to the effects of climate change, and one species at risk considered highly vulnerable.

4.2 Earth science values

Brockville Long Swamp Fen Provincial Park contains elements of the Lower Ordovician marine nearshore depositional environment, the Onaway Phase Glacial Environment, Gribben Phase Nonglacial Environment, the Proglacial Environment theme and the Champlain Sea. The earth science features in the park are typical of the area; they are also captured in DuPont Provincial Park, Rideau River Provincial Park and Voyageur Provincial Park. Earth science elements represented in the park are poorly exposed due to significant organic cover and are therefore considered to be regionally significant.

4.3 Cultural heritage values

A Stage 1 archaeological assessment for the park was completed in 2019 (Past Recovery Archaeological Services Inc., 2019). While no cultural heritage resources have been found within the park boundary, there has been limited systematic

archaeological research around the park. The archaeological assessment report indicates that some portions of the park are considered to have high archaeological potential. While much of the park consists of permanently water-saturated wetlands, portions of the park that include elevated lands possess potential for the recovery of both pre-Contact and post-Contact archaeological resources.

5 Summary of pressures

Various pressures affect the values in Brockville Long Swamp Fen Provincial Park. Some pressures may be addressed within the park, such as managing invasive species populations and human disturbance. Others will require adapting to or mitigating pressures that occur outside the boundary of the provincial park, such as effects from climate change and uses on adjacent land.

5.1 Pressures on natural heritage values

Pressures that are known, or suspected to occur now or in the future, and that could have a considerable impact on natural heritage values if left unmanaged include:

- invasive species, including non-native forest pests and wildlife diseases (e.g., phragmites, narrow-leaved cattail, dog strangling vine, hemlock woolly adelgid, emerald ash borer, snake fungal disease);
- unauthorized use and human disturbance within the park (e.g., unauthorized trails, motorized vehicle use, trampling, hunting, dumping);
- uses and management actions on adjacent lands (e.g., utility corridor maintenance, road salt, roadside mowing, road mortality, herbicide use);
- fragmentation (e.g., roads);
- encroachment (e.g., timber removal);
- illegal collection/poaching;
- changes in water quality, quantity, or flow patterns (e.g., roads, culverts);
- changes in insect-prey food availability;
- increased vulnerability of small, isolated populations (e.g., rare fen communities);
- climate change; and,
- hyperabundant wildlife.

5.2 Pressures on cultural heritage values

Cultural heritage resources have not yet been found within the park (Section 4.3) and given the lack of facilities and use there are no specific pressures on potential cultural

heritage values. There is potential for natural erosion to impact any undiscovered archaeological resources within the park.

6 Zoning

Provincial parks are divided into zones based on the sensitivity of natural and cultural values, potential for recreational uses and desired degree of development. Different policies are applied to each type of zone to ensure they are managed appropriately.

As the management needs and intent are consistent throughout the park, only one zoning category has been assigned in Brockville Long Swamp Fen Provincial Park. Zoning for the park is shown in Figure 2 and described below.

6.1 Nature Reserve Zone

Nature reserve zones protect significant earth and/or life sciences features and typically have minimal development.

Zone NR1 – Nature Reserve (174 ha)

Description: The entire park is within the NR1 zone. Any future park additions will also be included within this zone.

Management intent: This zone has important natural heritage values associated with the provincially significant wetland complex, as well as the upland and old field areas of the park. In this zone, ecosystems will continue to exist in their natural state and free from disturbance. Management activities will focus on the protection and restoration of plant communities, particularly the rare and sensitive fen communities, and may also include management of old field and upland areas. Emphasis will be put on protection and restoration of species at risk, addressing invasive species, and compliance and enforcement as needed to prevent detrimental human disturbance.

7 Policies

7.1 Resource management policies

7.1.1 Industrial activities

The following activities are prohibited in Brockville Long Swamp Fen Provincial Park:

- commercial timber harvest;
- generation of electricity (except for in-park use);

- extracting aggregate, topsoil or peat;
- prospecting, staking mining claims, developing mineral interests or working mines; and,
- other industrial uses.

There are no commercial facilities or operations within the park. No new facilities or operations will be permitted.

7.1.2 Fisheries

The park does not provide desirable sport fishing opportunities and none are expected. Should fishing activities occur in the park they are subject to provincial and federal fisheries legislation (e.g., *Fish and Wildlife Conservation Act, 1997*; *Fisheries Act* (Canada)) as set out in the Ontario Recreational Fishing Regulations Summary. Commercial fishing and commercial bait harvesting are prohibited in the park.

7.1.3 Wildlife

In general, wildlife will not be managed. However, animal populations (including native wildlife that is hyperabundant or has the potential to become hyperabundant) may be managed or individual animals may be controlled when essential to human health and safety, the health of the species, or to protect park values or ecological integrity. Where population management or animal control is necessary, techniques that have minimal effects on other components of the park's environment will be used. Wildlife population management may be undertaken directly by Ontario Parks or through partnerships under the supervision of Ontario Parks.

Projects to maintain, enhance, rehabilitate or restore native wildlife habitat, and to protect species and habitats against the effects of climate change, will be considered and implemented where feasible and appropriate (also see Section 7.1.4).

Sport hunting is prohibited within the park.

Commercial fur harvest and bear management operations are prohibited in the park.

7.1.4 Vegetation

Vegetation management will be directed toward promoting the health and diversity of native vegetation communities and the park's ecological integrity. Projects to enhance or restore native vegetation will be considered and implemented where feasible and appropriate. Vegetation management can occur anywhere in the park; however, focus will be on areas where significant species, habitats or vegetation communities (e.g., fen communities) are present.

Vegetation management actions can include, but are not limited to:

- restoring, naturalizing or enhancing natural areas;
- native species planting or seeding;
- prescribed burning (Section 7.1.8);
- re-introducing native species or enhancing native species populations, where appropriate and feasible; and,
- controlling invasive species within the park, including along the park boundary (Section 7.1.7).

Where planting or seeding is necessary, species native to the eco-district will be used. Where feasible native seeds and plants from the park, and/or genetic sources of native species that originate in or near the park or eco-district will be used.

Pesticides (including herbicides, fungicides, insecticides, etc.) may be used to control invasive species (Section 7.1.7), to control insects or disease (Section 7.1.5), to protect or restore native species habitat, or to protect or restore rare ecosystems. Mechanical and other non-chemical forms of vegetation removal will be the preferred alternative to chemical herbicides, if feasible and effective. Ontario Parks will also offer recommendations, as appropriate, to encourage municipal vegetation maintenance practices adjacent to the park boundary that align with park management interests and protection of park values (Section 5.1).

Dead or dying trees that are infested with damaging insects or disease may be cut, chipped and removed from the park to reduce or eliminate the spread of infestation if appropriate.

7.1.5 Insects and disease

The occurrence of native insects and diseases is recognized as an integral component of the park's ecology. Native insects and diseases will be allowed to progress naturally, unless there is a specific threat to the park's natural heritage values or ecological integrity. If an outbreak of native insect or disease species threatens the park's natural heritage values or ecological integrity the outbreak may be controlled, if feasible, using species-specific controls whenever possible. If control is undertaken, it will be directed as narrowly as possible to the specific insect or disease, so as to have minimal effects on the surrounding environment.

7.1.6 Species at risk

Species at risk and their habitats will be protected in a manner consistent with the *Endangered Species Act, 2007*, regulations and guidelines, and other relevant policy or best practices.

The park may undertake management actions for species at risk, as supported by research and directed through approved recovery strategies and government response statements or other species-specific management plans. Actions may include, but are not limited to:

- habitat restoration or enhancement;
- population monitoring and enhancement;
- access control to prevent trampling and illegal collection (Section 7.3.2); and
- public and staff education.

Existing populations may be augmented, and extirpated native species may be reintroduced, if biologically feasible and desirable for perpetuating park values and maintaining or enhancing ecological integrity.

7.1.7 Alien and invasive species

Alien species are plants, animals and microorganisms introduced by human actions outside their natural past or present distribution. These species may originate from other continents, countries, provinces, or from other parts of Ontario. Alien species will not be deliberately introduced into the park.

Invasive species are alien species that are harming, or likely to harm, the natural environment in Ontario. Invasive species will be addressed in a manner consistent with the *Invasive Species Act, 2015*, regulations and guidelines, Ontario's Invasive Species Strategic Plan, and other relevant documents or best practices.

Where possible, Ontario Parks will work to eradicate or control invasive species in Brockville Long Swamp Fen Provincial Park. Invasive species control will aim to reduce or prevent impacts to native species, biodiversity and ecosystem function. Control activities will be adapted based on the best available information and may be carried out through partnerships (Section 7.3.1). Control actions may include, but are not limited to:

- manual, non-chemical and chemical forms of vegetation management (Section 7.1.4);
- monitoring effectiveness of control actions and to detect new occurrences (Section 7.1.12);
- access control (Section 7.3.2); and,
- public and staff education.

Ontario Parks may notify adjacent landowners of invasive species management in the park and will work with landowners, when feasible and appropriate, to help manage invasive species along the park boundary.

7.1.8 Fire management

The Wildland Fire Management Strategy provides strategic direction for the management of wildland fire in Ontario. Fire management in provincial parks is guided by the Fire Management Policy for Provincial Parks and Conservation Reserves and the associated guideline.

The goal of fire management in provincial parks is to promote and encourage the use of fire as a natural ecological process for the maintenance and restoration of ecological integrity. The park is located outside of the fire region of Ontario. Municipalities provide forest fire protection services for fires that start or spread into the park. Ontario Parks will maintain communication, as needed, with municipality staff regarding fire response and management in the park.

Prescribed burning

Prescribed burning is the deliberate, planned and knowledgeable application of fire by authorized personnel to a specific land area to accomplish predetermined ecological or hazard reduction objectives.

Resources permitting, prescribed burning activities may be considered to manage vegetation (e.g., in the open field habitat to maintain grassland) through a carefully implemented plan. Prescribed burning plans for the park will be developed in accordance with the approved provincial policies, methods and protocols (e.g., MNRF Prescribed Burn Manual).

Based on current science, fire is not desirable as an ecological management tool in fen habitat (Barkley, 2019). As such, prescribed burning is not recommended in the fen habitat in the park.

7.1.9 Cultural heritage

Cultural heritage values will be identified, assessed and managed in accordance with applicable legislation and policies. If cultural heritage values are discovered, Ontario Parks will follow requirements outlined in relevant cultural heritage policy.

Ontario Parks will work with the Algonquins of Ontario and other Indigenous communities to identify and map Indigenous values within the park.

7.1.10 Land management

Agreements between NCC and Ontario Parks confirm that both parties are committed to the management of Brockville Long Swamp Fen Provincial Park for protection of natural heritage values. Lands within the park that are owned by NCC may be transferred to the Crown.

Many of the pressures on park values originate from adjacent lands (Section 5), and these potential impacts are exacerbated by the fragmented nature of the park. Actions that may be implemented to address these pressures include, but are not limited to:

- enforcement of unauthorized access and use (Section 7.3.2);
- improved fencing (Section 7.3.3);
- signage noting access restrictions and/or park values (Section 7.3); and,
- communication and/or collaboration with adjacent property owners (Section 7.1.7).

A major electrical power distribution line within a 40-metre wide cleared right-of-way is adjacent to the park's west boundary. A utility corridor for electrical and telephone services runs adjacent to the park within the County Road 6 road allowance. Two Hydro One utility lines cross the park. Ontario Parks will seek to ensure that any alterations and maintenance to transmission lines within the park minimize impacts to park values and ecological integrity, by recommending alternative methods and establishing appropriate mitigation measures. The expansion of utility lines in the park may be considered and is subject to PPCRA approval. As opportunities arise, Ontario Parks will also take steps to encourage that maintenance of adjacent utility lines be done using practices that reduce impacts on the wetland and adjacent park lands (Section 7.3.1).

Ontario Parks supports the acquisition of land through sale or donation to enhance protection or park management. Adjacent lands with similar values would be of highest priority. If lands are offered for sale or donation, staff will evaluate how they contribute to park objectives. The acquisition of suitable properties would be subject to the availability of financial and human resources. Priority areas for addition to the park are:

- lands within or adjacent to the Brockville Long Swamp Fen ANSI (provincially significant wetland), particularly those that reduce fragmentation of the park;
- lands adjacent to the park; and,
- other lands that have provincially or regionally significant earth or life science values, or enhance the ability to protect park values.

Landowners within the Brockville Long Swamp Fen ANSI and adjacent to the park boundary will be encouraged to manage their lands in a manner complementary to protection of park values.

7.1.11 Water management

If opportunities arise, Ontario Parks will support efforts to better understand pressures and maintain and/or restore natural wetland hydrology and water quality in Brockville Long Swamp Fen Provincial Park. Ontario Parks will continue to offer recommendations, as appropriate, for maintenance of roadways and utility corridors that

consider impacts and opportunities for improvement to natural wetland hydrology and water quality.

7.1.12 Science and research

Ontario Parks may carry out inventories and monitoring to inform park management decisions. Such efforts will be undertaken based on established methods and best practices.

Partnerships may be formed to implement research, inventorying or monitoring in the park (Section 7.3.1).

Only non-intrusive research, inventory and monitoring activities will be considered within the park.

Priority will be given to projects that provide a benefit to the protected area system. The following subject areas are particularly suitable to Brockville Long Swamp Fen Provincial Park:

- life science inventories, including a complete inventory of the park's flora and fauna, and Ecological Land Classification mapping;
- regular monitoring of invasive species including existing populations, impacts to park values, and to detect new occurrences;
- research and monitoring of ecological processes and the health of the wetland ecosystem (e.g., hydrology, water quality, flora and fauna, and species at risk), including impacts of activities occurring within and adjacent to the park; and,
- research regarding the effects of climate change on wetland communities.

Any external party who wishes to carry out research in Brockville Long Swamp Fen Provincial Park must obtain a research authorization letter from the park superintendent. Researchers may also need to obtain additional permits or approvals (e.g., *Endangered Species Act, 2007* permits).

7.2 Recreation management policies

7.2.1 Recreation and travel

As a nature reserve class park established to protect provincially significant and sensitive natural values, recreational use and visitation of Brockville Long Swamp Fen is not encouraged. There are no existing recreational facilities or authorized trails in the park. Access control measures will be implemented where necessary to mitigate unauthorized access (Section 7.3.2).

The following activities are not permitted:

- aircraft landing;
- camping;
- canoeing/kayaking;
- horseback riding;
- hunting (Section 7.1.3);
- motorized vehicle use for recreational purposes including, but not limited to, all-terrain vehicle use and snowmobiling;
- mountain biking;
- pedestrian travel including hiking, snowshoeing and cross-country skiing; and,
- physical and virtual geocaching.

Wildlife viewing and nature appreciation may occur from roadside locations.

Refer to Section 7.1.2 for policies regarding sport fishing.

7.3 Operations and development policies

Brockville Long Swamp Fen Provincial Park is currently non-operating. Non-operating parks typically provide minimal to no facilities and services.

Visitation of Brockville Long Swamp Fen Provincial Park is discouraged to minimize human disturbance of the park's sensitive features. Signage may be posted to prohibit public entry into the park, if deemed necessary to protect sensitive park values.

Mechanized travel for non-recreation purposes will be limited and subject to approval from the park superintendent. Examples of activities where mechanized travel may be approved include emergency search and rescue, resource management and utility corridor maintenance.

Public information regarding the park will be limited to existing literature on the Brockville Long Swamp Fen ANSI, available at local MNR offices and from other sources.

Only an absolute minimum of development will be considered within Brockville Long Swamp Fen Provincial Park. All development undertaken by Ontario Parks, or by partners on its behalf, will comply with this management plan and will be carried out in accordance with approved site and development plans that meet development standards for provincial parks.

7.3.1 Partnerships

Partnerships and collaborative efforts that contribute to achieving the park's purpose, vision, objectives and implementation of this management plan may be considered.

Activities undertaken as part of a partnership or collaborative effort must be in keeping with the PPCRA, its regulations, Ontario Parks' policies, and all other applicable legislation.

7.3.2 Access

There are no designated public park access points. Two unauthorized access points that exist along County Road 6 will be decommissioned. An existing gate limits access where the park boundary meets the 6th Concession Road. To protect important and sensitive park values, access to the park is highly discouraged and areas may be closed. This may be supported by physical barriers (e.g., fencing) and will be communicated through signage and other methods (Section 7.3.3).

If access for research or stewardship purposes is required by individuals or groups that are not staff of Ontario Parks, advance authorization from the park superintendent is required.

7.3.3 Infrastructure

Existing infrastructure (e.g., fencing) will be monitored and may be maintained, improved or replaced. New infrastructure may be constructed in support of park management where negative impacts to significant species, vegetation communities and wetlands can be mitigated, and will be limited to:

- signage to identify park boundaries and/or prohibit public access or to identify the significance of the area; and,
- fencing or other barriers to restrict access (Section 7.3.2).

7.3.4 Education and heritage appreciation

In keeping with the park's non-operating status and discouraged use, no educational programming will occur.

8 Implementation priorities

Table 1 summarizes and prioritizes actions identified in the management plan. Implementation of actions may be subject to:

- other applicable legislation and policies (e.g., environmental assessment);
- site planning; and,
- the availability of financial and human resources.

Implementation of actions may also include further opportunities for consultation, as required.

Table 1: Implementation priorities

Actions identified in management plan	Section
Short-term priorities	
Restrict access Decommission unauthorized access points	7.3.2
Signage Sign park boundary to restrict access and identify significance of the wetland if needed	7.1.10, 7.3.2, 7.3.3
Medium-term priorities	
Fencing/physical barrier improvements as needed.	7.1.10, 7.3.2, 7.3.3
Long-term priorities	
Develop partnerships Continue to work with partners to secure lands for addition to the park in order to protect a larger area of the ANSI and provincially significant wetland.	7.1.10
Provide recommendations, as appropriate, to encourage work adjacent to the park boundary (e.g. utility line and road maintenance) that considers and minimizes impacts on the wetland and park values.	7.1.10, 7.1.11
Work to eradicate or control invasive species, including working with landowners to conduct invasive species management along the park boundary.	7.1.7

9 Examination and adjustment of management plan

This management plan will be examined in accordance with the provisions of the PPCRA to determine whether it is still relevant, effective and current, or if adjustments are needed. In circumstances where the plan is not providing sufficient direction, or to

address specific issues or pressures, it can be examined prior to the next scheduled examination.

10 References

Barkley, Erica. 2019. Brockville Long Swamp Fen Provincial Park Life Science Consideration for Management Statement. Ontario Ministry of the Environment, Conservation and Parks, Peterborough, Ontario.

Conrad, Mark. 2001. Brockville Long Swamp Fen: General Life Science Information and Some Vegetation Community Descriptions. Ontario Ministry of Natural Resources, Kingston, ON.

[Endangered Species Act, 2007, S.O. 2007, c. 6](#)

[Environmental Assessment Act, R.S.O. 1990, c. E.18](#)

[Fish and Wildlife Conservation Act, 1997, S.O. 1997, c. 41](#)

[Fisheries Act, R.S.C, 1986, c. F-14](#)

[Invasive Species Act, 2015, S.O. 2015, c. 22](#)

Ministry of Natural Resources. 1992. Ontario Provincial Parks: Planning and Management Policies, 1992 Update. Provincial Parks and Natural Heritage Policy Branch. Toronto: Queen's Printer for Ontario.

Ministry of Natural Resources. 2006. A Technical Guide for Cultural Heritage Resources for Projects Planned Under the Class Environmental Assessment for Ministry of Natural Resources Resource Stewardship and Facility Development Projects and the Class Environmental Assessment for Provincial Parks and Conservation Reserves. Peterborough: Queen's Printer for Ontario.

Ministry of Natural Resources and Forestry. 2014. Ontario's Protected Areas Planning Manual and Guidelines: 2014 Edition. Peterborough: Queen's Printer for Ontario. 33 pp.

Ministry of Natural Resources and Forestry. 2018. Ontario Parks Operating Standards. Peterborough.

Ministry of the Environment, Conservation and Parks and Ministry of Natural Resources and Forestry. 2020. Fire Management Policy for Provincial Parks and Conservation Reserves, PAM 7.02 (proposed update).

[Ontario Heritage Act, R.S.O. 1990, c. O. 18](#)

Past Recovery Archaeological Services Inc. 2018. Draft Stage 1 Archaeological Assessment of Brockville Long Swamp Fen Provincial Park, Various Lots, Concession

6, Geographic Township of Elizabethtown, now Township of Elizabethtown-Kitley, United Counties of Leeds and Grenville, Ontario. Prepared for: Ontario Parks, Southeast Zone, Ministry of Environment, Conservation and Parks, Peterborough, ON.

[Provincial Parks and Conservation Reserves Act, 2006, S.O. 2006, c. 12](#)

Schlesinger, David. 1987. Long Swamp Fen: Biophysical Features, Land Uses, and Management Recommendations. Prepared for the Ontario Heritage Foundation, Toronto, ON.

Wester, M.C., B.L. Henson, W.J. Crins, P.W.C. Uhlig and P.A. Gray. 2018. The Ecosystems of Ontario, Part 2: Ecodistricts. Ontario Ministry of Natural Resources and Forestry, Science and Research Branch, Peterborough, ON. Science and Research Technical Report TR-26. 474 p. + appendices

White, David J. 1992. Life Science Areas of Natural and Scientific Interest in Site District 6-11: A Review and Assessment of Significant Natural Areas. Prepared for the Ontario Ministry of Natural Resources, Kemptville, ON.