

Number/Numero:

PR-20-000248

This permit is issued under the authority of section 78.3 of the *Mining Act* and the Exploration Plans and Exploration Permits Regulation (O. Reg. 308/12). It is subject to the provisions of the Act and regulation as well as the terms and conditions included in this permit.

Ce permis est émis conformément aux dispositions de section 78.3 de la *Loi sur les mines* et des règlements et est sujet aux restrictions et dispositions de ce lois et règlements ainsi qu'aux conditions ci-énoncées.

Note: The issuance of this permit does not relieve the applicant from the responsibility of acquiring any other agency, board, government, etc. approval as may be required nor does it relieve the permittee from the requirements of any other legislation or guarantee access to the land.

Remarque : La délivrance de ce permis n'exempte pas le demandeur de l'obligation d'obtenir l'autorisation de tout autre organisme, commission, gouvernement, etc. qui pourrait être exigée, n'exempte pas le titulaire des dispositions de toute autre loi et ne garantit pas l'accès à la terre.

Project Details/ Détails sur le projet

Project Name/ Titre du projet

North Rock

Qualified Supervisor/Superviseur qualifié

Michel Dumoulin

This Permit is issued to: Ce Permis est délivré a:

Name of Permittee:/Nom du détenteur:

Metalcorp Limited

Mailing Address:/Adresse postale:

490 Maureen Street Thunder Bay ON P7B 6T2

To conduct early exploration activities from/ Pour effectuer des activités d'exploration du (yyyy/mm/dd):

2021/01/20

to: 2024/01/19

On claim/lease/licence of occupation number(s):/Sur le numéro(s) du claim/bail/permis d'occupation:

310803, 287488, 160126, 323530, 311309, 330892, 326785, 271022, 123717, 278181, 271021, 235574, 312758, 179007, 274773, 227616, 225599, 220319, 115776, 232874, 125618, 302700, 272354, 154582, 100153, 168955, 206278, 215158, 142121, 123840, 343360, 123734, 123735, 214898, 196285, 160931, 329487, 329512, 283007, 213511, 116668, 279695, 279696, 101994, 145494, 164275, 204066, 128979, 224193, 158248, 312757, 212138, 287485, 310800, 158247, 115978, 310748, 154923, 227629, 287484, 340575, 179746, 220336, 142139, 115796, 232976, 230294, 159600, 320900, 166273, 270243, 167532

as per your exploration permit application date:/conformément a la demande de permis d'exploration en date du:

2020/08/05

for the purpose of Permit activities:

- Mechanized Drilling (assembled weight >150kg)/ Forage mécanisé (poids assemblé >150 kg)
- Mechanized Stripping (>100m² in 200m radius)/ Décapage mécanisé (>100 m² dans un rayon de 200 m)
- Pitting and Trenching (>3m³ in 200m radius)/ Creusement de fosses et de tranchées (>3 m³ dans un rayon de 200 m)
- Line Cutting (>1.5m width)/ Découpage des quadrillages (>1,5 m de largeur)
- Other (Early exploration activities for which Director has required a permit)/Autre (Activités d'exploration préliminaires pour laquelle le Directeur a demandé un permis):

for the purpose of Plan activities:

- Ground geophysical survey requiring a generator (Les levés géophysiques au sol qui nécessitent l'utilisation d'une génératrice)
- Mechanized Drilling (assembled weight <150kg)/ Forage mécanisé (poids assemblé <150 kg)
- Mechanized Stripping (<100m² in 200m radius)/ Décapage mécanisé (<100 m² dans un rayon de 200 m)
- Pitting and Trenching (1-3m³ in 200m radius)/ Creusement de fosses et de tranchées (1-3 m³ dans un rayon de 200 m)
- Line Cutting (<1.5m width)/ Découpage des quadrillages (<1,5 m de largeur)

Subject to the following conditions:/Et sous les conditions suivantes:

1. The Permittee shall keep this permit or a true copy thereof on the permit area./Le détenteur conserver ce permis ou une copie conforme sur les lieux des travaux.
2. The person in charge of the operation conducted under this permit shall produce and show this permit or the true copy kept on the exploration permit area to any inspector whenever requested by the officer./Le responsable des travaux couverts par ce permis doit produire le permis ou sa copie conforme si un inspecteur lui demande.
3. The requirements outlined in Schedule 1 of Ontario Regulation 308/12 and applicable Provincial Standards for Early Exploration/ Les exigences générales identifier à l'annexe 1 du Règlement de l'Ontario 308/12 et les normes provinciale relatives a l'exploration préliminaire.
4. Other terms and conditions as listed on this permit./Autres termes et conditions énoncées sur ce permis.

Place of Issue/Emis a:

Thunder Bay

Issued by/Emis par:

Scott Burgess, Director of Exploration

Date of Issue/Date émis (yyyy/mm/dd, aaaa/mm/jj):

2021/01/20

Signature of Director/Signature du directeur:



Additional Terms and Conditions:

Autre termes et conditions:

1. Mobilization/Demobilization

Written notice shall be provided to the Ministry of Northern Development and Mines as follows:

- a) not less than two (2) weeks prior to commencing the early exploration activities authorized by this Permit which, for greater certainty, shall include the mobilization of personnel and equipment to the site required for carrying out those activities;
- b) after a period of temporary suspension of activities of greater than four (4) weeks, not less than one (1) week prior to recommencing the early exploration activities authorized by this permit;
- c) not less than two (2) weeks prior to the anticipated final demobilization of personnel and equipment required for carrying out the early exploration activities authorized by this Permit; and

Collection of personal information, if any, on this form is authorized by sections 7, 78.2, 78.3, and subsection 178.2(1) of the *Mining Act* for the purpose of creating a public record as described in section 37 of the *Freedom of Information and Protection of Privacy Act*. This information may also be posted in a modified form on the Ministry of Northern Development and Mines website and on the Environmental Registry for public comment. Questions about this collection should be directed to the Mineral Exploration and Development Section, Ministry of Northern Development and Mines, 933 Ramsey Lake Road, Sudbury ON P3E 6B5. Telephone 705-670-5815.

Preferred language of
correspondence

- English
 French

Fields marked with an asterisk (*) are mandatory.

1. Project Details

Project Name *

North Rock

Name of Early Exploration Proponent *

Metalcorp Limited

Is the proposed early exploration area within the project area for an existing filed closure plan? *

- Yes No

Are there any mine hazards identified in the [Abandoned Mines Information System \(AMIS sites\)](#) in your project area? *

- Yes No

Enter the Universal Transverse Mercator Coordinates (UTM) in North American Datum 83 (NAD 83) Grid for the centre of your project area

Zone (N) *

15

Easting (m) *

495025

Northing (m) *

5394150

2. Exploration Logistics and Detailed Information

Will explosives be used for any activity/activities? If yes describe in detail which activities require the explosives, where they will be stored, and any other relevant information.

No

What commodity or commodities are being sought in the work program?

Palladium (Pd), Platinum (Pt), Copper (Cu)

How will you be transporting personnel to the exploration site for all activities? Describe in detail.

Pick up trucks to main highway, secondary and logging roads leading to the property, then with ATV's (4 wheeler quads), skidder and nodwell depending field condition, then snowmobiles if the program extends to winter.

How will you be mobilizing/demobilizing equipment to and from the exploration site for all activities? Describe in detail.

The equipment will be mob/demob with a transport truck (flat bed truck) as far as it can enter/exit close to/from the property, then with heavy machine such as dozer, skidder or nodwell as needed, then with the help of pick up trucks and ATV's quad machines (snowmachines if winter) to carry and pull material to working sites.

What type of equipment will you be using for all of the early exploration activities?

As described above such as skidder, nodwell, ATV'S or snowmachines depending the season, and as much as possible pick up trucks. A backhoe (excavator) will be used for stripping work, and a drill rig for NQ size core drilling will be brought on site with the heavy machines above, including the flat bed truck. Wajax pumps and other light material will be transported with pick up trucks or ATV's or snowmachines.

What type of drilling will take place? (e.g. core drilling, reverse circulation)
This will be core drilling with NQ size diameter.

Do you anticipate the removal of the drill casing?

Yes No

If yes, when will you be removing it?

Immediately 3 to 6 months 6 to 12 months 1 to 2 years

For the exploration activities you have selected in your early exploration submission please fill in the associated details (required for all activities proposed). *

Geophysical surveys requiring a generator ▶ Type of Survey Induced Polarization

Line cutting ▶ Estimated total line length 50000 metres

Mechanized Stripping ▶ Planned Number of stripped locations 4
Estimated total area of stripping 2000 square metres

Pitting and Trenching of Bedrock ▶ Planned Number of Pits/Trenches 0

Mechanized Drilling ▶ Planned drill hole diameter 4.76 centimetres
 1 - 5 pads
 6 - 10 pads
 11 - 15 pads
 16 - 20 pads
 > 20 pads

Please identify any non-prescribed activity/activities you will be undertaking to support the prescribed early exploration activity/activities

Creating trails for the purposes of early exploration
 Creating roads for the purposes of early exploration
 Creating/setting up camp(s) to house personnel to perform your prescribed early exploration activities
Number of people in camp _____ Number of camps _____

Ground geophysical surveys without a generator
 Airborne geophysical surveys

Are you planning to store fuel or other hazardous materials on the property? *

Yes No

Please provide any other information relevant to this project.

Metalcorp field workers and contractors/diamond drillers associated with the project should be come to work from the town of Fort Frances or cottage rentals in the surrounding area. Some casings could possibly break and then cut to ground level when left on site. Crossing permits with be managed with MNRF.

3. Signature

Name (Last Name, First Name)

Dumoulin Mitch

Email Address

mitch@metalcorp.ca

Signature

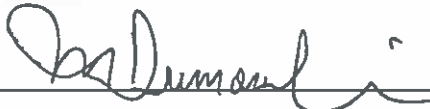

Date (yyyy/mm/dd)

2020/07/02

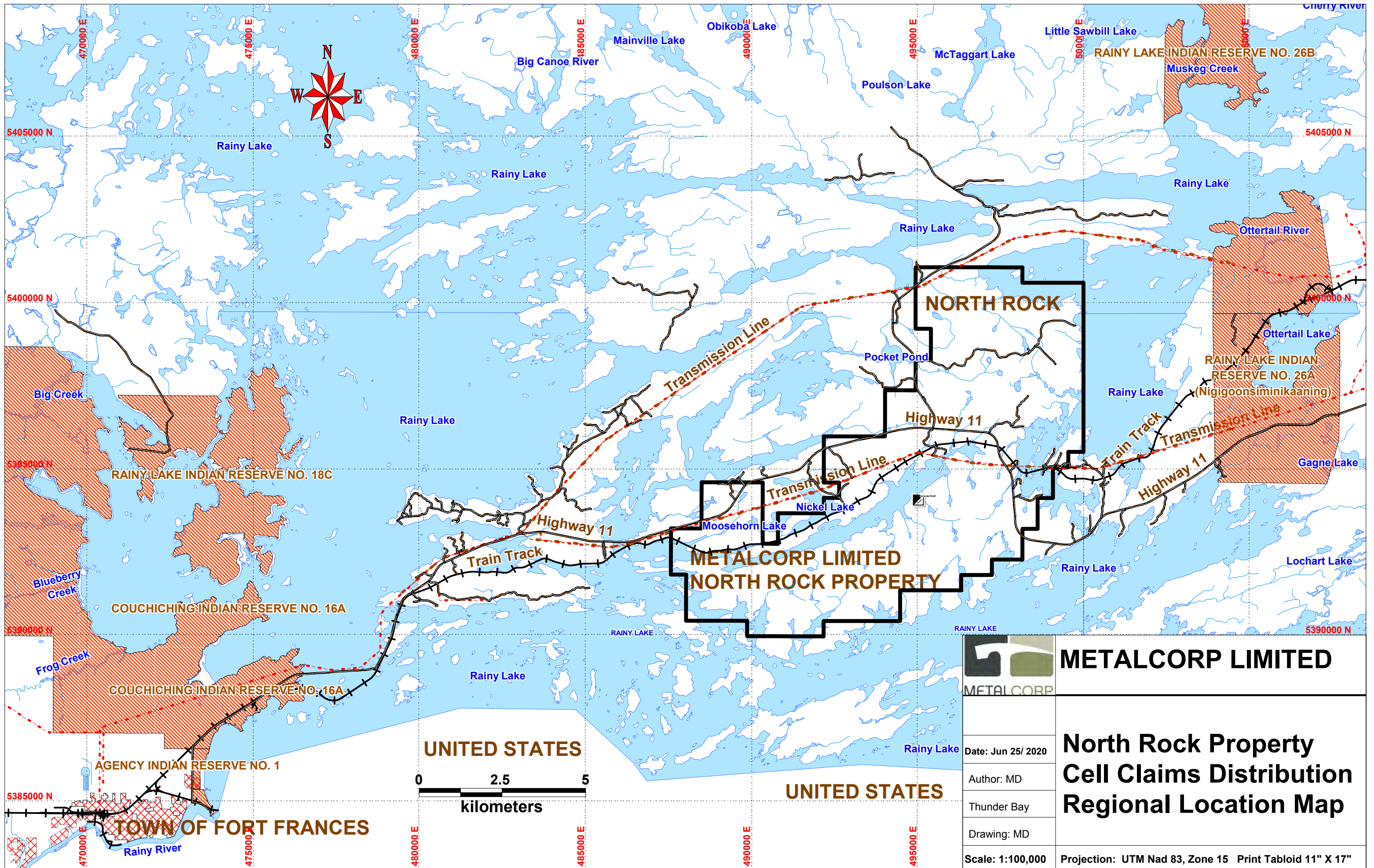

METALCORP LIMITED

Date: Jun 25/ 2020
 Author: MD
 Thunder Bay
 Drawing: MD
 Scale: 1:100,000

**North Rock Property
 Cell Claims Distribution
 Regional Location Map**

Projection: UTM Nad 83, Zone 15 Print Tabloid 11" X 17"

NORTH ROCK PROPERTY

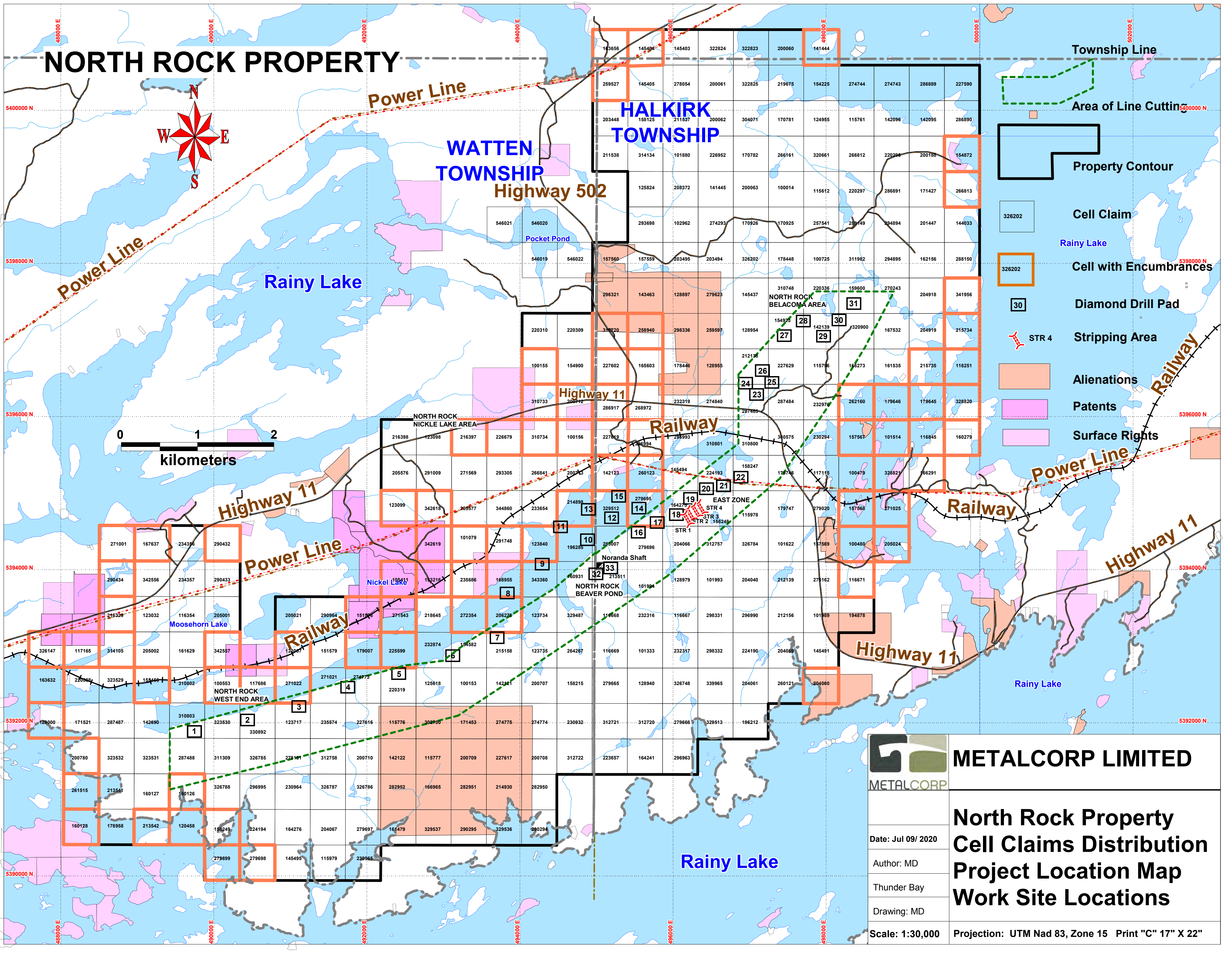
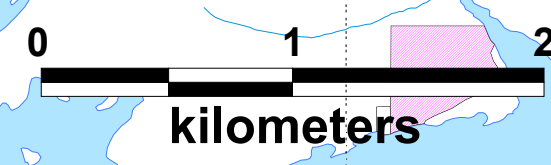
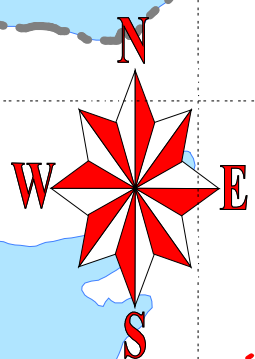

- Township Line
- Area of Line Cutting
- Property Contour
- Cell Claim
- Rainy Lake
- Cell with Encumbrances
- Diamond Drill Pad
- STR 4 Stripping Area
- Alienations
- Patents
- Surface Rights



METALCORP LIMITED

North Rock Property Cell Claims Distribution Project Location Map Work Site Locations

Date: Jul 09/ 2020
 Author: MD
 Thunder Bay
 Drawing: MD
 Scale: 1:30,000

Projection: UTM Nad 83, Zone 15 Print "C" 17" X 22"