



Exploration Permit/Permis d'exploration

Number/Numero:

PR-20-000035

This permit is issued under the authority of section 78.3 of the *Mining Act* and the Exploration Plans and Exploration Permits Regulation (O. Reg. 308/12). It is subject to the provisions of the Act and regulation as well as the terms and conditions included in this permit.

Ce permis est émis conformément aux dispositions de section 78.3 de la *Loi sur les mines* et des règlements et est sujet aux restrictions et dispositions de ce lois et règlements ainsi qu'aux conditions ci-énoncées.

Note: The issuance of this permit does not relieve the applicant from the responsibility of acquiring any other agency, board, government, etc. approval as may be required nor does it relieve the permittee from the requirements of any other legislation or guarantee access to the land.

Remarque : La délivrance de ce permis n'exempte pas le demandeur de l'obligation d'obtenir l'autorisation de tout autre organisme, commission, gouvernement, etc. qui pourrait être exigée, n'exempte pas le titulaire des dispositions de toute autre loi et ne garantit pas l'accès à la terre.

Project Details/ Détails sur le projet

Project Name/ Titre du projet

Seagull Project

Qualified Supervisor/Superviseur qualifié

Cathy Salo

This Permit is issued to: Ce Permis est délivré a:

Name of Permittee:/Nom du détenteur:

White Metal Resources

Mailing Address:/Adresse postale:

684 Squier Street, Thunder Bay, Ontario, P7B 4A8

To conduct early exploration activities from/ Pour effectuer des activités d'exploration du (yyyy/mm/dd):

2020/09/25

to:

2023/09/24

On claim/lease/licence of occupation number(s):/Sur le numéro(s) du claim/bail/permis d'occupation:

101524 124627 176642 183389 184815 215000 232616 260729 335384

As per the project map(s) and Activity Details Report, all of which are attached hereto and which form part of this permit/
Selon la/les carte(s) du projet et le Rapport Détaillé des Activités, tous qui sont attachés ici et qui forment partie du permis

for the purpose of Permit activities:

- Mechanized Drilling (assembled weight >150kg)/ Forage mécanisé (poids assemblé >150 kg)
- Mechanized Stripping (>100m² in 200m radius)/ Décapage mécanisé (>100 m² dans un rayon de 200 m)
- Pitting and Trenching (>3m³ in 200m radius)/ Creusement de fosses et de tranchées (>3 m³ dans un rayon de 200 m)
- Line Cutting (>1.5m width)/ Découpage des quadrillages (>1,5 m de largeur)
- Other (Early exploration activities for which Director has required a permit)/Autre (Activités d'exploration préliminaires pour laquelle le Directeur a demandé un permis):

for the purpose of Plan activities:

- Ground geophysical survey requiring a generator (Les levés géophysiques au sol qui nécessitent l'utilisation d'une génératrice)
- Mechanized Drilling (assembled weight <150kg)/ Forage mécanisé (poids assemblé <150 kg)

- Mechanized Stripping (<100m² in 200m radius)/ Décapage mécanisé (<100 m² dans un rayon de 200 m)
- Pitting and Trenching (1-3m³ in 200m radius)/ Creusement de fosses et de tranchées (1-3 m³ dans un rayon de 200 m)
- Line Cutting (<1.5m width)/ Découpage des quadrillages (<1,5 m de largeur)

Subject to the following conditions:/Et sous les conditions suivantes:

1. The Permittee shall keep this permit or a true copy thereof on the permit area./Le détenteur conserver ce permis ou une copie conforme sur les lieux des travaux.
2. The person in charge of the operation conducted under this permit shall produce and show this permit or the true copy kept on the exploration permit area to any inspector whenever requested by the officer./Le responsable des travaux couverts par ce permis doit produire le permis ou sa copie conforme si un inspecteur lui demande.
3. The requirements outlined in Schedule 1 of Ontario Regulation 308/12 and applicable Provincial Standards for Early Exploration/ Les exigences générales identifier à l'annexe 1 du Règlement de l'Ontario 308/12 et les normes provinciales relatives à l'exploration préliminaire.
4. Other terms and conditions as listed on this permit./Autres termes et conditions énoncées sur ce permis.

Place of Issue/Emis a:

Thunder Bay

Issued by/Emis par:

Scott Burgess, Director of Exploration

Date of Issue/Date émis (yyyy/mm/dd, aaaa/mm/jj):

2020/09/25

Signature of Director/Signature du directeur:



Additional Terms and Conditions:

Autre termes et conditions:

Written notice shall be provided to the Ministry of Northern Development and Mines as follows:

a) not less than two (2) weeks prior to commencing the early exploration activities authorized by this Permit which, for greater certainty, shall include the mobilization of personnel and equipment to the site required for carrying out those activities;

b) after a period of temporary suspension of activities of greater than four (4) weeks, not less than one (1) week prior to recommencing the early exploration activities authorized by this permit;

c) not less than two (2) weeks prior to the anticipated final demobilization of personnel and equipment required for carrying out the early exploration activities authorized by this Permit; and

delivered by email to TBAY-MDLB@ontario.ca

Collection of personal information, if any, on this form is authorized by sections 7, 78.2, 78.3, and subsection 178.2(1) of the *Mining Act* for the purpose of creating a public record as described in section 37 of the *Freedom of Information and Protection of Privacy Act*. This information may also be posted in a modified form on the Ministry of Northern Development and Mines website and on the Environmental Registry for public comment. Questions about this collection should be directed to the Mineral Exploration and Development Section, Ministry of Northern Development and Mines, 933 Ramsey Lake Road, Sudbury ON P3E 6B5. Telephone 705-670-5815.

Preferred language of
correspondence

English

French

Fields marked with an asterisk (*) are mandatory.

1. Project Details

Project Name *

Seagull

Name of Early Exploration Proponent *

White Metal Resources

Is the proposed early exploration area within the project area for an existing filed closure plan? *

Yes No

Are there any mine hazards identified in the [Abandoned Mines Information System \(AMIS sites\)](#) in your project area? *

Yes No

Enter the Universal Transverse Mercator Coordinates (UTM) in North American Datum 83 (NAD 83) Grid for the centre of your project area

Zone (N) *

16

Easting (m) *

356,536

Northing (m) *

5,432,411

2. Exploration Logistics and Detailed Information

Will explosives be used for any activity/activities? If yes describe in detail which activities require the explosives, where they will be stored, and any other relevant information.

No explosives plan to be used.

What commodity or commodities are being sought in the work program?

Pt, Pl, Au

How will you be transporting personnel to the exploration site for all activities? Describe in detail.

Main access to the property by pickup truck with further access gained by ATV.

How will you be mobilizing/demobilizing equipment to and from the exploration site for all activities? Describe in detail.

Equipment will be mobilized/demobilized from site using pickup trucks, trailers, flat beds and ATVs.

What type of equipment will you be using for all of the early exploration activities?

Early exploration equipment could include; bulldozer, excavator, diamond drill rig.

What type of drilling will take place? (e.g. core drilling, reverse circulation)
Exploration activities would consist of diamond core drilling.

Do you anticipate the removal of the drill casing?

Yes No

If yes, when will you be removing it?

Immediately 3 to 6 months 6 to 12 months 1 to 2 years

For the exploration activities you have selected in your early exploration submission please fill in the associated details (required for all activities proposed). *

Geophysical surveys requiring a generator	▶ Type of Survey	_____
Line cutting	▶ Estimated total line length	_____ metres
Mechanized Stripping	▶ Planned Number of stripped locations	_____
	Estimated total area of stripping	_____ square metres
Pitting and Trenching of Bedrock	▶ Planned Number of Pits/Trenches	_____
Mechanized Drilling	▶ Planned drill hole diameter	7.5 centimetres
	<input type="checkbox"/> 1 - 5 pads	
	<input type="checkbox"/> 6 - 10 pads	
	<input type="checkbox"/> 11 - 15 pads	
	<input checked="" type="checkbox"/> 16 - 20 pads	
	<input type="checkbox"/> > 20 pads	

Please identify any non-prescribed activity/activities you will be undertaking to support the prescribed early exploration activity/activities

- Creating trails for the purposes of early exploration
 Creating roads for the purposes of early exploration
 Creating/setting up camp(s) to house personnel to perform your prescribed early exploration activities
Number of people in camp _____ Number of camps _____
 Ground geophysical surveys without a generator
 Airborne geophysical surveys

Are you planning to store fuel or other hazardous materials on the property? *

Yes No

Please provide any other information relevant to this project.

May do minor trail clearing work (clearing of overgrowth) on previously existing grids/trails on the property.

3. Signature

Name (Last Name, First Name)

Salo, Cathy

Email Address

csalo@whitemetalres.com

Signature

Date (yyyy/mm/dd)

2020/01/29

Save Form

Print Form

Clear Form

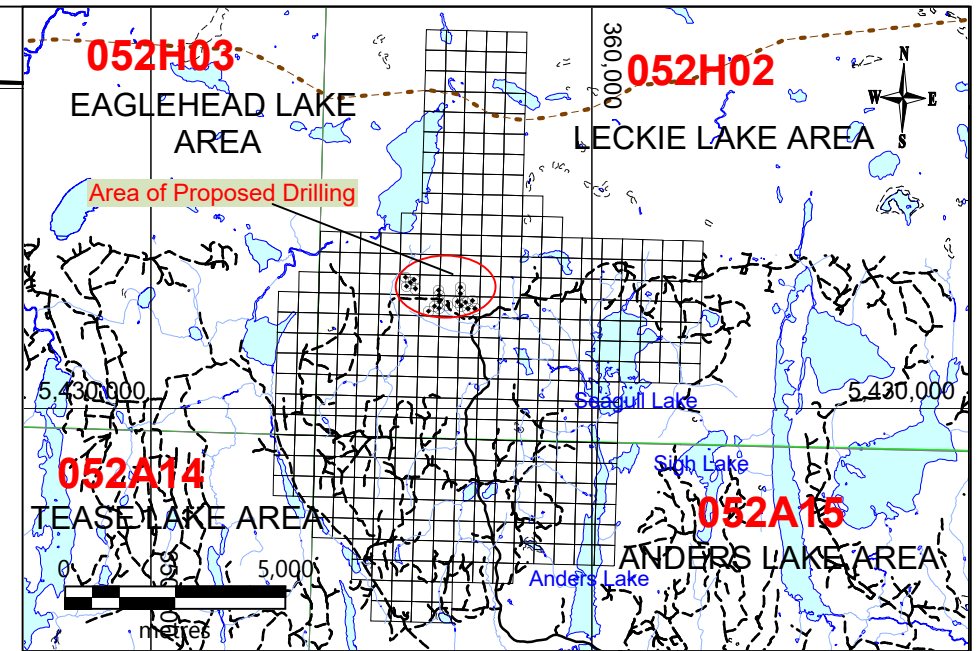
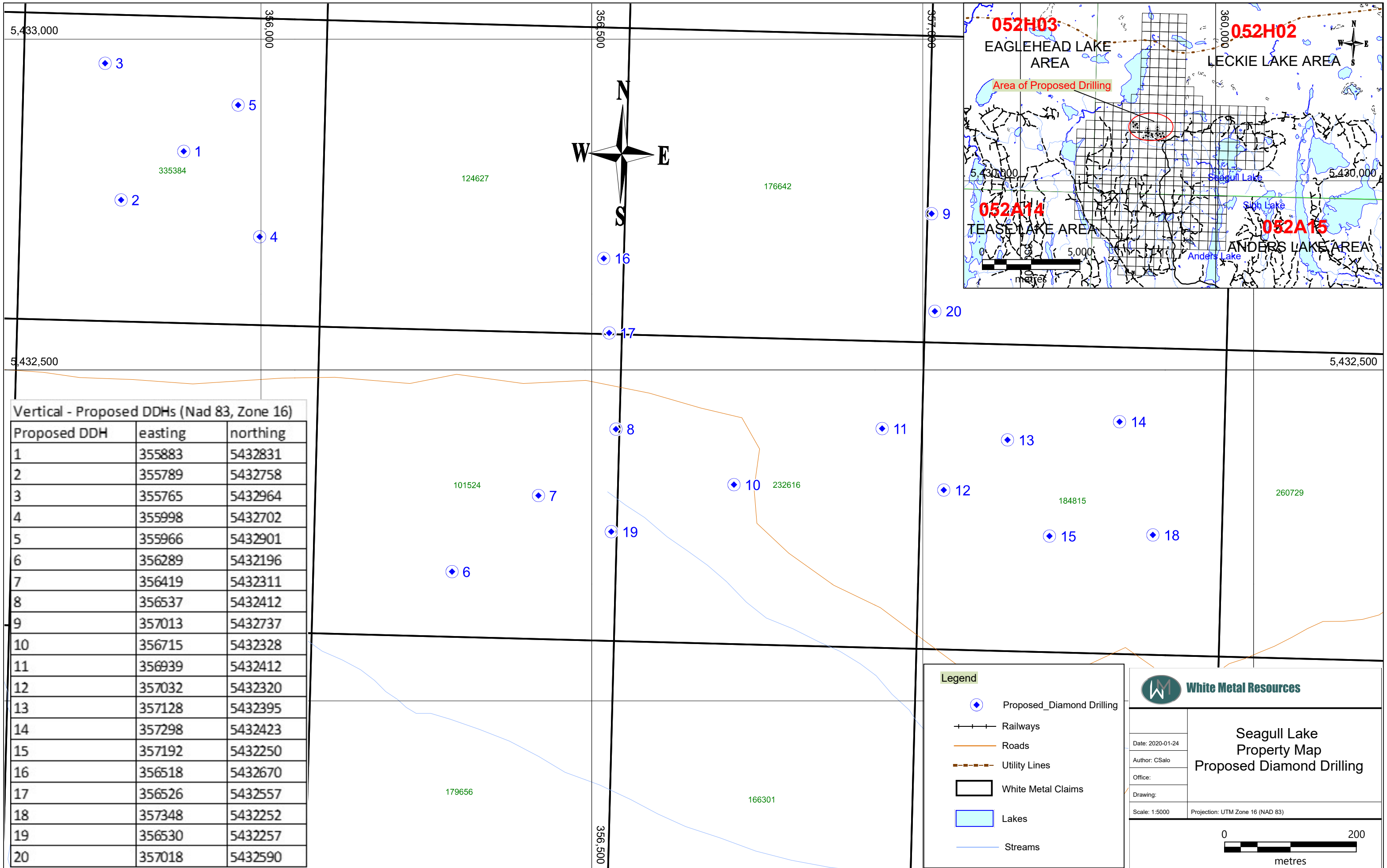

Vertical - Proposed DDHs (Nad 83, Zone 16)

Proposed DDH	easting	northing
1	355883	5432831
2	355789	5432758
3	355765	5432964
4	355998	5432702
5	355966	5432901
6	356289	5432196
7	356419	5432311
8	356537	5432412
9	357013	5432737
10	356715	5432328
11	356939	5432412
12	357032	5432320
13	357128	5432395
14	357298	5432423
15	357192	5432250
16	356518	5432670
17	356526	5432557
18	357348	5432252
19	356530	5432257
20	357018	5432590

Legend

- Proposed_Diamond Drilling
- Railways
- Roads
- Utility Lines
- White Metal Claims
- Lakes
- Streams

White Metal Resources

Seagull Lake Property Map
Proposed Diamond Drilling

Date: 2020-01-24
 Author: CSalo
 Office:
 Drawing:
 Scale: 1:5000 Projection: UTM Zone 16 (NAD 83)

0 200
metres