

AGRICULTURAL LAND



PIN: # 61315-0142



300 m

WABI CREEK

Owners:

(DALTON & JOANNE POTTER)

PROPOSED EASEMENT

DALTON & JOANNE POTTER

39 m

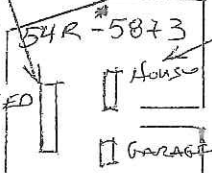

NORTH QUARRY RD

Bush Land

"SERVIENT LANDS"

PIN: 61315-0273
N 1/2 LOT 1, CONC 2 HENWOOD

69 ha ±

Owner:

(DALTON POTTER)

MOFFAT CREEK

DISTANCE TO BARN

BARN

BARN

WABI PIT LINE

[- - -] - PROPOSED EASEMENT BOUNDARY: 10m x 900m

[- - -] - SEASONALLY MAINTAINED TOWNSHIP ROAD: APROX 300 M

"DOMINANT LANDS"

PIN: 61315-0153
N 1/2 LOT 2
CONC 2 HENWOOD

Vacant agricultural land